

2021 LG Smart Inverter SINGLE COMMERCIAL AIRCONDITIONER



LG Electronics

<http://www.lg.com>
<http://partner.lge.com>
<http://blog.lghvacstory.com/>

Distributed by



CONTENTS



Why LG Smart Inverter? 05

Line up 07

Core benefit of LG Smart Inverter Single CAC 10

- Energy Saving • The Evolution of LG Technology • Reliability
- Art of Cooling • Intelligence • Corrosion Resistance

LG Smart Inverter Single CAC 21

- Ceiling Mounted Cassette • 1Way Ceiling Cassette • Floor Standing Unit
- Ceiling Suspended Unit • Ceiling Concealed Duct

Control Solution 45

WHY LG SMART INVERTER?

LG Inverter technology is applied to various electronics including refrigerators and washing machines which continuously receive global attention. Their best quality is the excellent level of technology provided by LG, a reputable electronic provider. LG is also known for its comprehensive HVAC provider while continuing innovation in technology. LG's latest Smart Inverter Single CAC solutions are all equipped with the company's advanced Smart Inverter technology

ENERGY SAVING



Superior Efficiency

LG advanced inverter technology provides high level energy saving



Quick Payback

Quick return on investment by saving electricity
(Payback period varies per products)

RELIABILITY



Revolutionary Scroll Compressor

High performance with stable & simple structure



Surge Protection

When High risk of compressor failure, Compressor protection



Wide Operation Range

As low as -15°C and as high as 48°C outdoor temperature

ART OF COOLING



Power cool(Jet Cool) mode

Powerful cooling with simple control



Long Distance Air Blow

Enables to deliver the air blow up to 20m from the indoor unit



Maximum Cooling Capacity

LG inverter can maximize it's capacity in order to cool effectively

INTELLIGENCE



Air purifying

Convenient & Cost effective 5 stage air purifying function



Smart Application

Mobile LGMV (SIMs) : Easy monitoring & diagnosis
LG ThinQ : Smart control by smartphone & google assistant



Human Detection

Automatic direction of airflow & operation by sensing human body

LINE UP



Product	1.5HP	2.0HP	2.5 HP	3.0 HP
	(Cooling Only) 220~240V, 1Phase, 50/60Hz			
1Way Cassette				
4Way Cassette				
Floor Standing				
Ceiling Suspended				
Low Static Duct				
Mid Static Duct				

4.0 HP	5.0 HP	6.0 HP	10.0 HP	15.0 HP	20.0 HP
(Cooling Only) 220~240V, 1Phase, 50/60Hz			(Cooling Only) 380V, 3 Phase, 60Hz		

ENERGY SAVING

SMART INVERTER

With LG's own Cutting-edge Inverter technology, high level EER can be achieved.



※ The EER level varies depending on the Capacity(kW) of each product
 ※ EER(Cooling) calculation = Rated Cooling capacity (w) / Rated input power (w)

ANNUAL ENERGY SAVINGS ESTIMATION

Electricity consumption are expected to decline by 25% compared to on/off model. (6.0 HP Floor standing)

Electricity Consumption

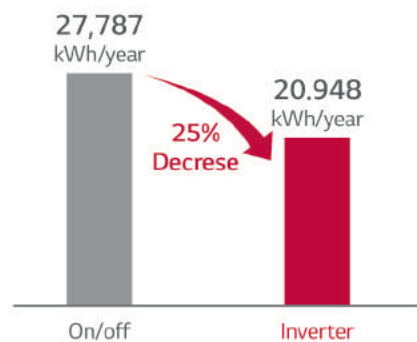

Electricity Cost

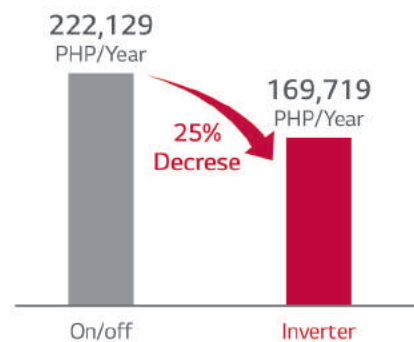

[Condition]
 - Capacity : 6.0 HP Floor standing
 - Operating time : 08:00-22:00
 - Cooling partial load and power consumption calculated based on yearly weather data (target indoor temperature: 22°C) Philippine (Manila)
 ※ This result can be different depending on actual environment
 ※ This energy & electric cost saving datas are simulated result with 'LG SCAC/RAC Inverter Payback' application
 ※ Initial cost of each product is based on market SRP (PHP)

PAYBACK

If you purchase the LG smart inverter, you can get back your investment within 1 Year 8 months.

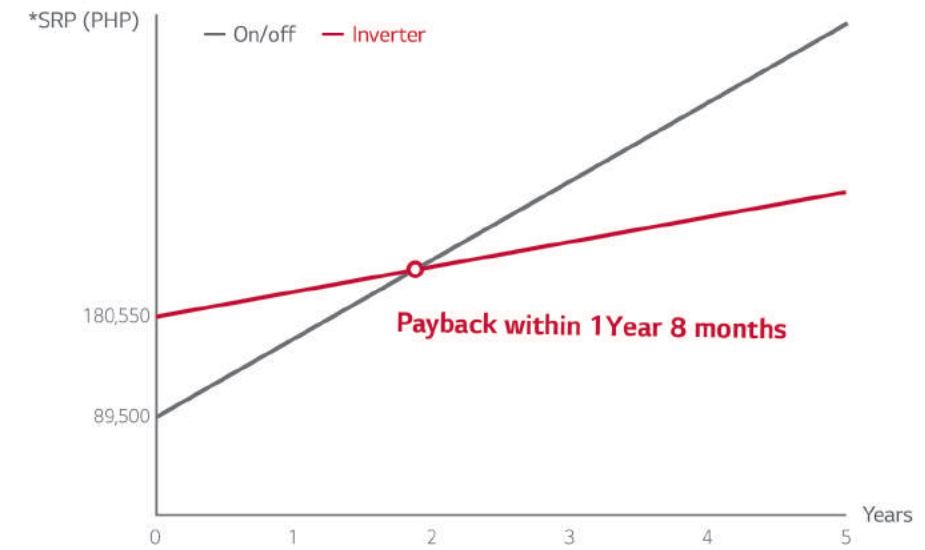

[Condition]
 - Capacity : 6.0 HP Floor standing
 - Operating time : 08:00-22:00
 - Cooling partial load and power consumption calculated based on yearly weather data (target indoor temperature: 22°C) Philippine (Manila)
 ※ This result can be different depending on actual environment
 ※ This energy & electric cost saving datas are simulated result with 'LG SCAC/RAC Inverter Payback' application
 ※ Initial cost of each product is based on market SRP (PHP)

You can easily simulate on mobile via payback app. (Install "LG SCAC / RAC Inverter Payback")

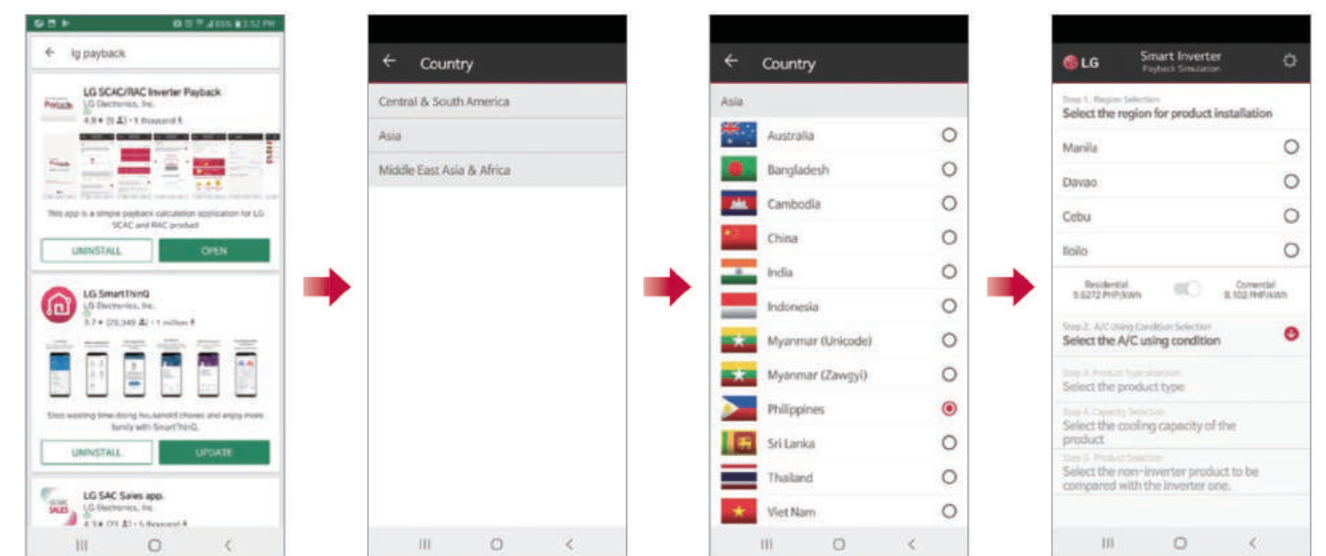

* Search "LG SCAC / RAC Inverter Payback" on Google Play store or App store.

THE EVOLUTION OF LG TECHNOLOGY

R1 Compressor™



Made in Korea

AR Movie of R1 technology

1. Down load R1 compressor AR application from Google play store.
2. Put the camera on the QR code. AR movie will be played on the QR code.
3. Select and see World Top technologies of LG R1 Scroll Compressor

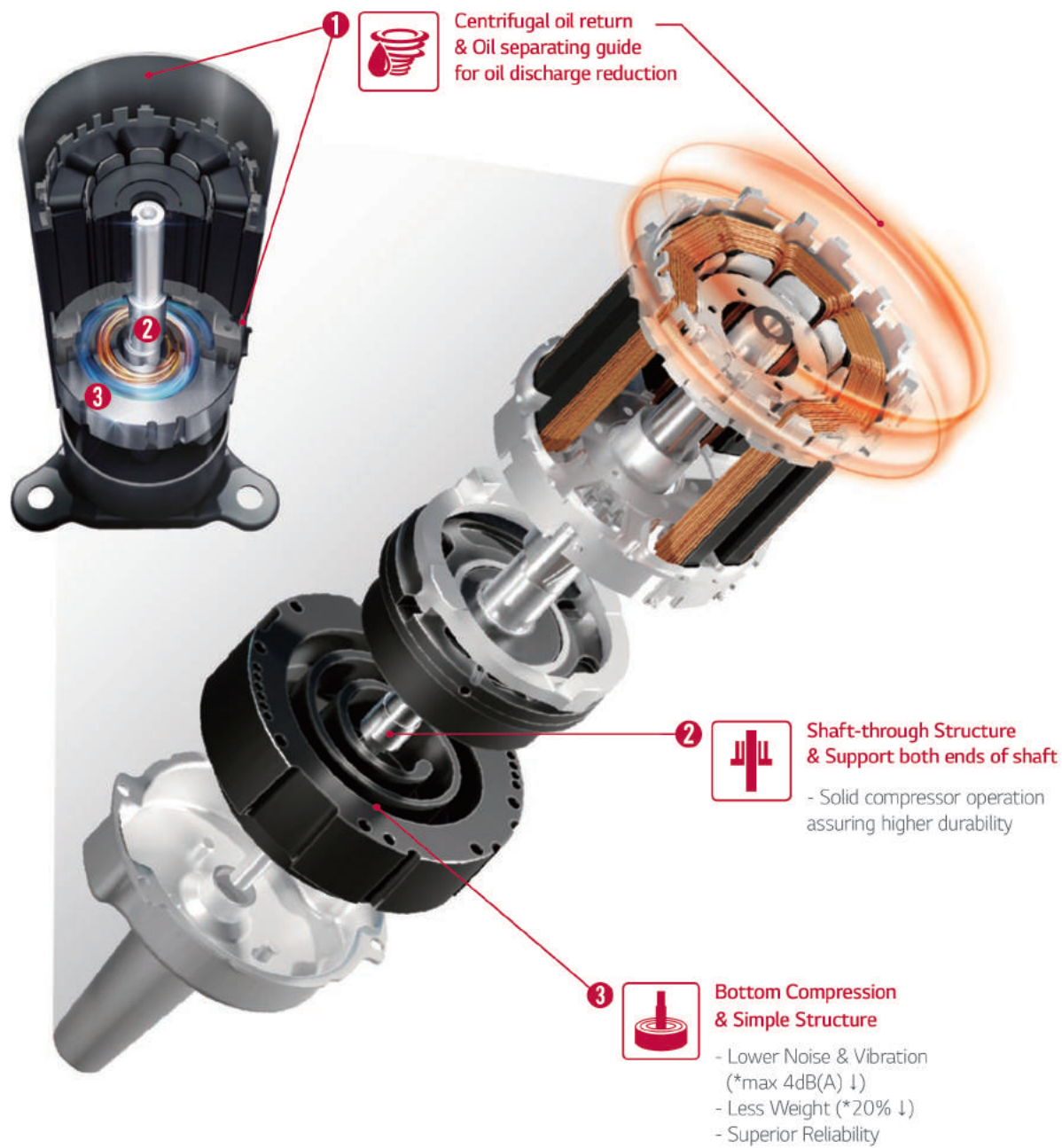

* LG Internal test result, Based on conventional compressor (Rotary type, GPT442M)
※ R1 Compressor is applied to 4, 5, 6 HP mode

REVOLUTIONARY SCROLL COMPRESSOR

Revolutionary Scroll Compressor is applied for high-efficiency and reliability. This type of compressor is more advanced compared to the conventional one, especially that the tilting motion of scroll has been improved. Further, the operation is improved compared to the conventional type.

- Scroll compressor with simple structure
- Low noise (high speed possible)
- 20% weight reduction (vs. conventional compressor)
- High efficiency (low load at low speed / total efficiency)
- Improved Tilting Motion of scroll

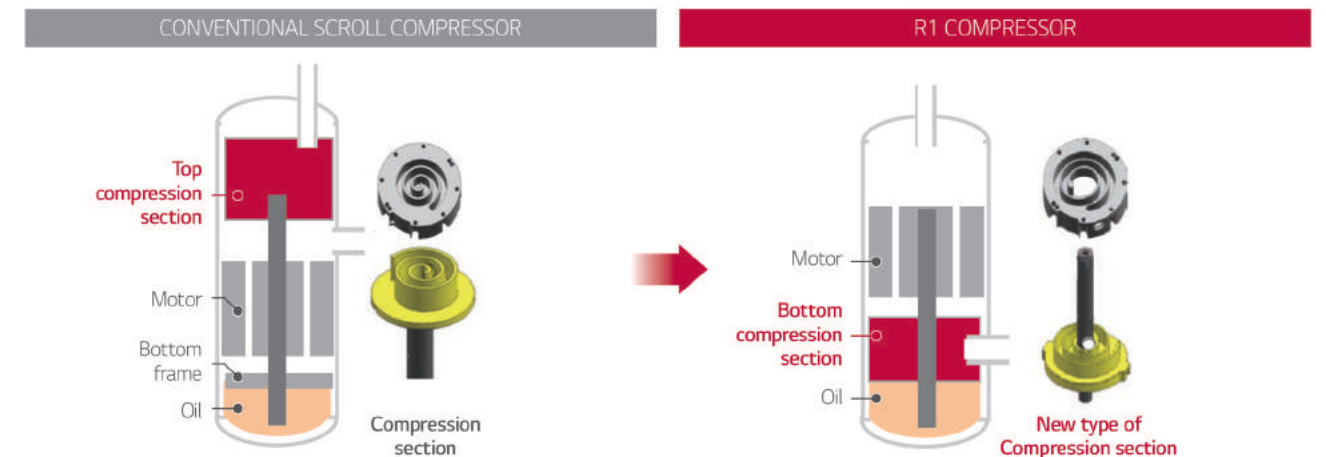

ADVANTAGES OF THE R1 COMPRESSOR STRUCTURE

R1 Compressor is more stable and simple compressing structure with low-vibration characteristics of scroll compressor.

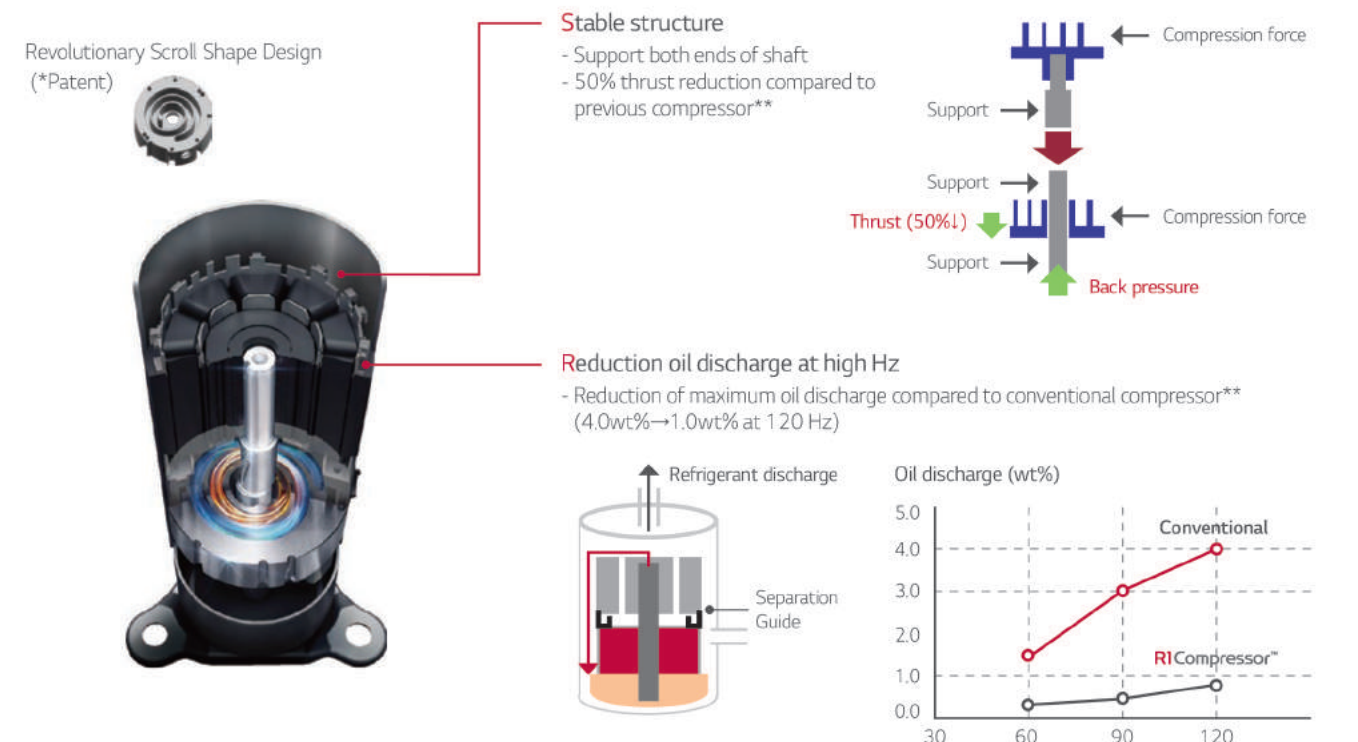

* LG Internal test result, Based on conventional compressor (Scroll type, JAB068MA)
** Patent registration number (S.Korea : 10-1059880, USA : RE46106)

RELIABILITY

POWER COOLING AT THE WIDE VOLTAGE RANGE

LG Smart inverter is able to operate at a wider voltage range than constant speed model

The voltage range of Inverter model that can operate continuously is **90%** wider than constant speed model.

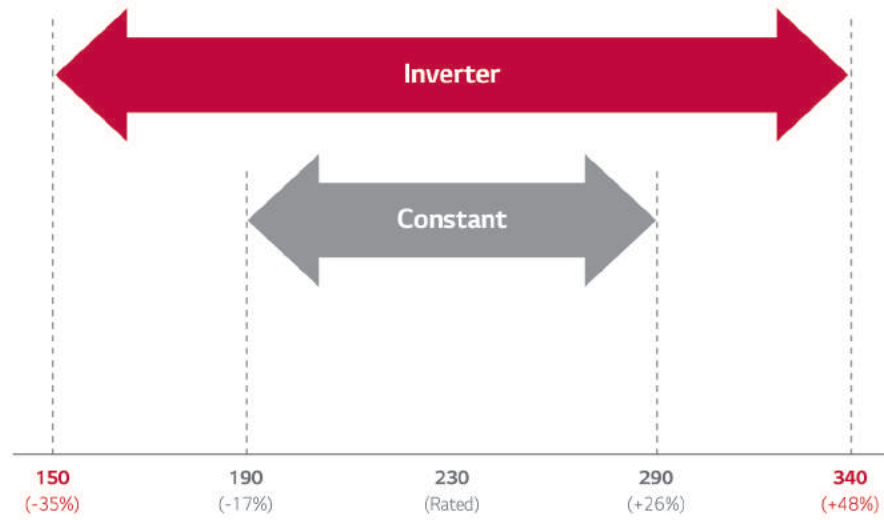

HIGH AND LOW VOLTAGE PROTECTION

Below low voltage limit, inverter compressor reduces frequency(Hz) and boost DC voltage, over high voltage limit, cuts off the relay to prevent damage of DC capacitor.

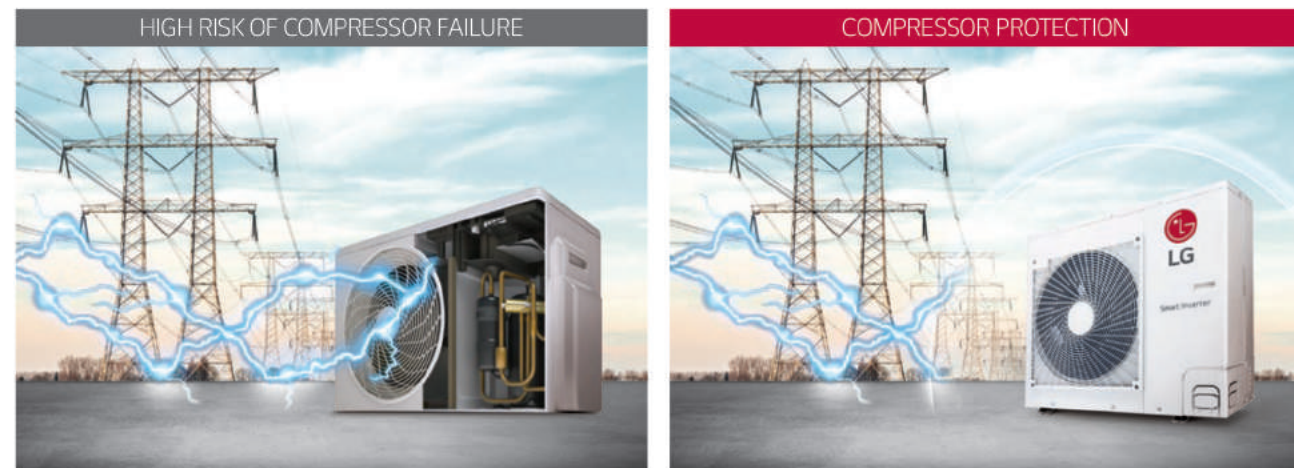

ADVANCED LONG PIPING DESIGN

Using LG products, Total pipe length can reach up to 50m and elevation difference can reach up to 30m. This advanced long piping design provides installation flexibility.

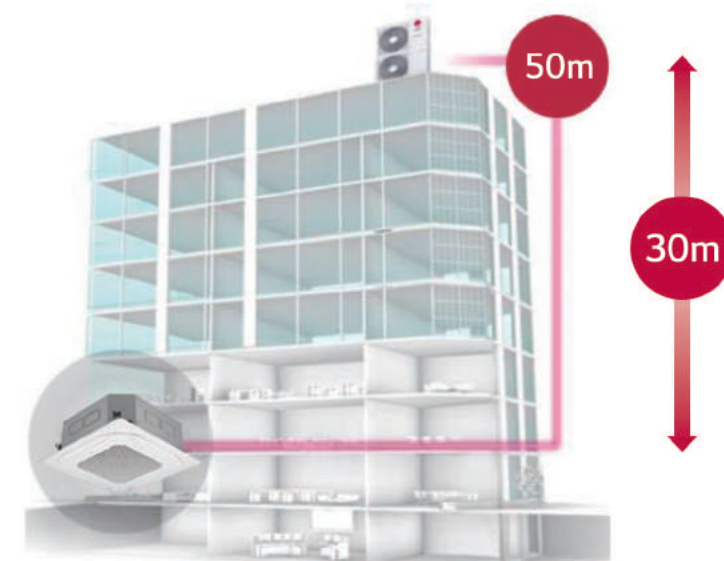

Applicable from 2.5 HP capacity models, under 2.5 HP models please refer to the specification page for detail

WIDE OPERATION RANGE

Product can be operated as low as -15°C and as high as 48°C outdoor temperature



※ Operation range is varies by product type and capacity, please check specification for detail information

ART OF COOLING

POWERFUL COOLING WITH SIMPLE CONTROL

Simply press the 'Power Cooling Mode' or 'Jet Cool' button on the wireless remote, LG provides the fast & efficient cooling.



* Actual product appearance may differ from the above simulated scene.

POWER COOLING AT THE LONG PIPE

It has a capacity of 10% higher more than constant model at the 50m pipe length.

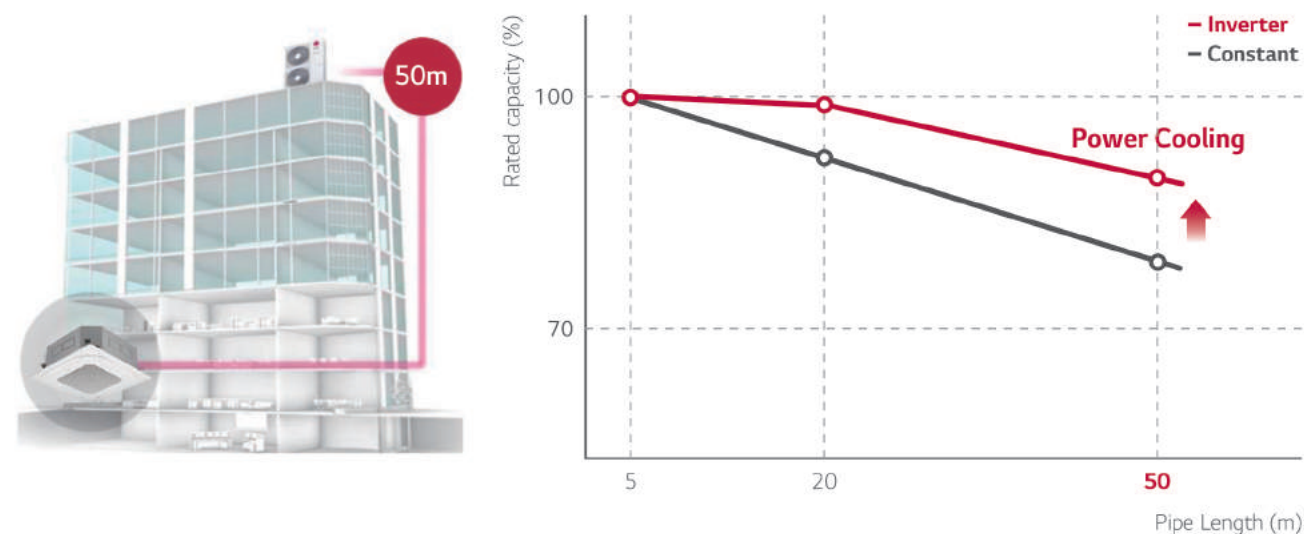

※ The data is based on the PDB of LG global model.
 ※ Test condition (Temperature) : 27 / 35 °C (Indoor / Outdoor)

LONG DISTANCE AIR BLOW

LG's advanced Fan technology enables to deliver the air blow up to 20m from the indoor unit.

* Distance is varies by product type

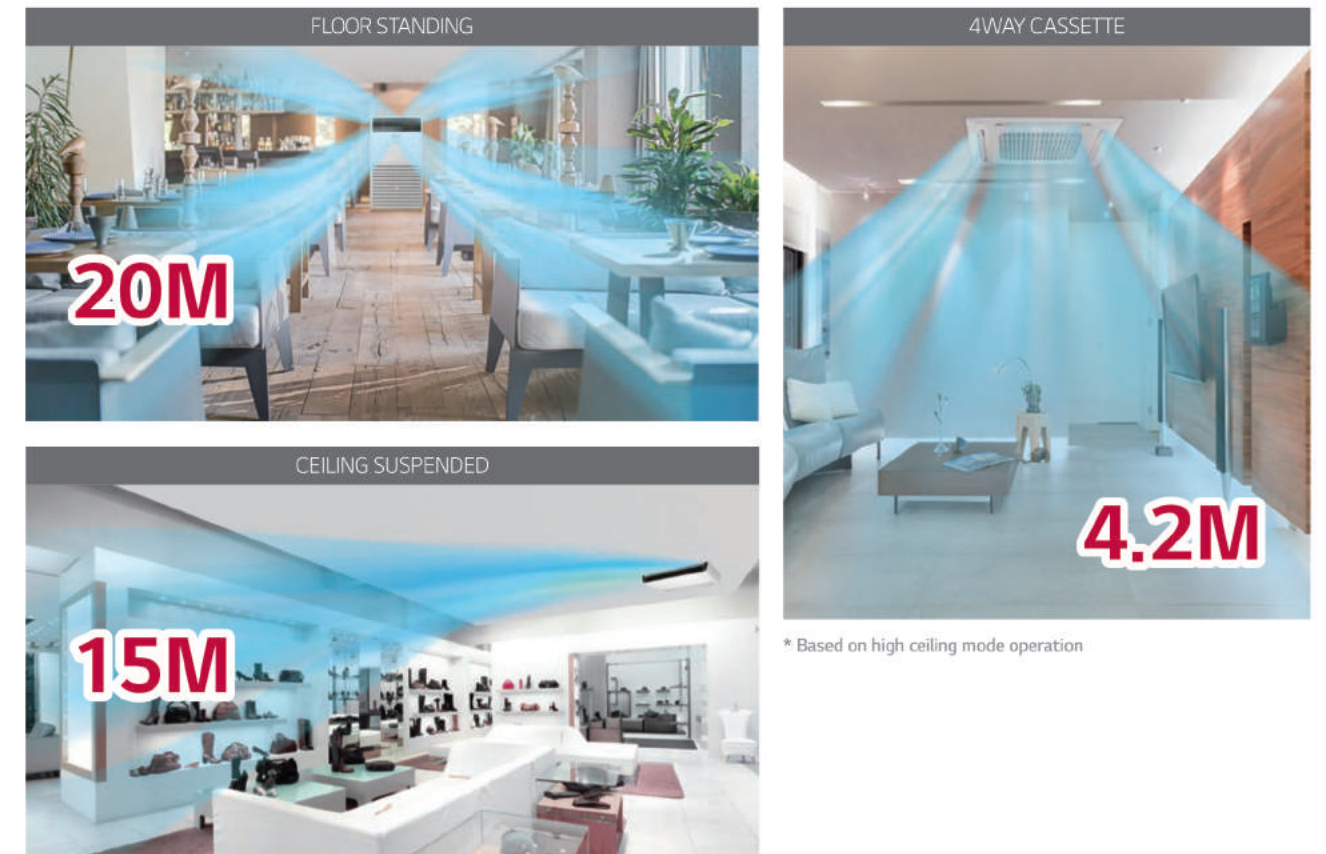

MAXIMUM COOLING CAPACITY

With Maximum and Minimum speed Inverter compressors, LG Smart Inverter achieves wider operation capacity range.

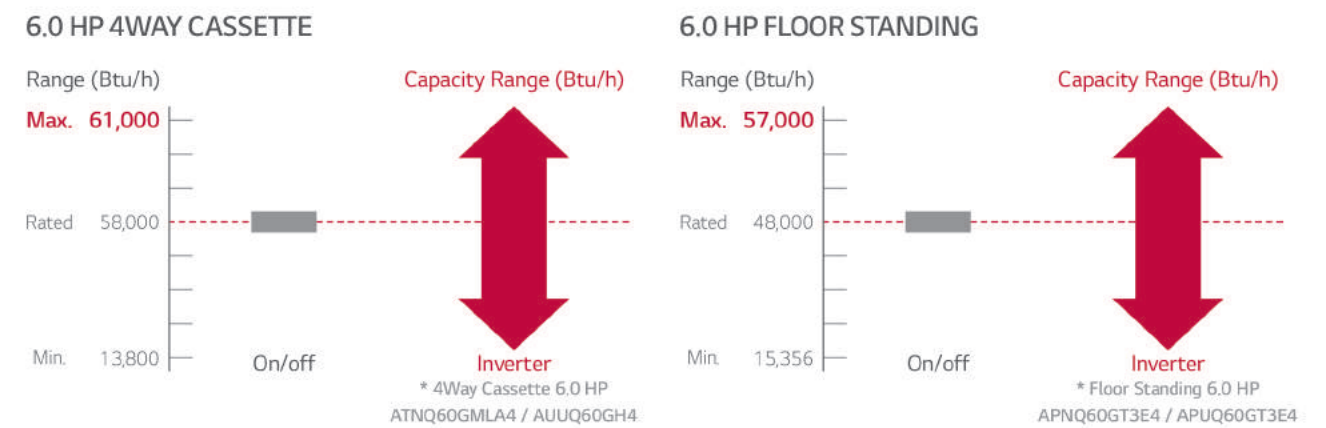

INTELLIGENCE

LARGE SCALE AIR PURIFICATION

1 Indoor unit can purify up to 147.0m³ space (Guaranteed by CAC certification for Korea domestic)



CAC Certification* for purification performance



4 Way 147.0 m²

* Based on RNW1450T2S model (Korean market model, Capacity 14.5kW)
* Test standard : KACA-CAC-2011

What is CAC Certification? (Korea certification)
The Korea Air Cleaning Association strictly tests the air cleaning function of air conditioner products and provide certification to the product that give credibility to consumers

CONVENIENT & COST EFFECTIVE 5 STAGE AIR PURIFYING FUNCTION

Air purifying filters & devices can be easily detached for maintenance

Component	Image	Maintenance
PM1.0 sensor		No need for replacement
Air purifying kit		5. Sterilization Ionizer No need for replacement
		4. Photocatalyst deodorizing filter Cleaning every 6 month (Dry)
		3. Ultra fine dust filter Cleaning every 6 month (Water)
		2. Dust electro charging No need for replacement
Panel		1. Pre filter Cleaning every 2 weeks (Water)

※ Please read manual carefully before washing filters

REAL TIME AIR QUALITY MONITORING

The condition of the air can be easily checked by various devices such as Indoor unit LED, Wireless/ Wired remote controller or Mobile phone

1 Indoor unit LED	2 Remote controller	3 Mobile device
LED indicates indoor air condition	Overall air quality, dust density level	Easy and simple control by application
		

※ Wi-Fi module and internet connection needed to access through mobile device

HUMAN DETECTION SENSOR & HUMIDITY SENSOR

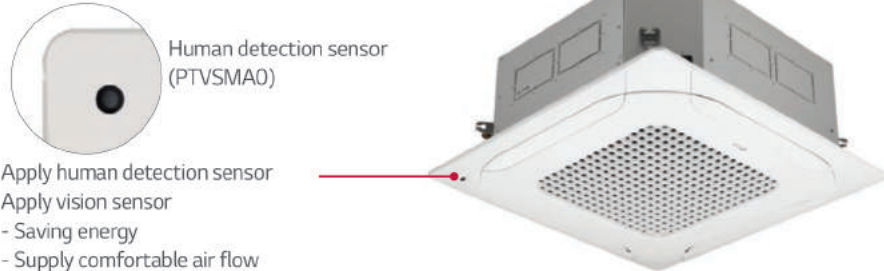

Human detection sensor (PTVSMAD)

Apply human detection sensor
Apply vision sensor

- Saving energy
- Supply comfortable air flow
- The sensor is an optional accessory that can only be applied on PT-MCGW0 (Cassette Panel)

※ Sensor is optional accessory (PTVSMAD) : only can be applied to PT-MCGW0 (Cassette Panel)

※ To use this function, new remote controller, PREMTB100 or PREMTBB10 is needed

HUMAN DETECTION PATTERN LEARNING

Saving energy by learning the absence pattern of user(group)

Human detection sensor activated	Human detection sensor deactivated	Human detection sensor activated
Presence	Absence	Presence
Conventional AI	A/C off after 30mins of absence	
AI 2.0 (New)	Pattern learning (ex. 30min) 30 / 60 / 90min setting available	
	Increase temperature 2°C after 5min absence, A/C off after 25min operation	
	5min learning A/C off A/C on	
	Absence 5min after absence 30min after absence Human detected	

INTELLIGENCE

LG ThinQ™

Control your air conditioners via using the smart internet devices as Android or iOS based smartphones.



Simple operation for various functions

- On / Off
- Mode Selection
- Current temperature
- Set temperature
- Vane Control
- Reservation
- Energy Monitoring
- Filter Management

※ Search "LG ThinQ™" on Google market or Appstore then download the app.
 ※ Wi-Fi modem (PWFMD200) is required by option.
 ※ In some countries, the use of the google assistant system may be restricted.

MOBILE LG MV

LG MV (Monitoring View) helps engineers to inspect and monitor air conditioning unit easily.



CORROSION RESISTANCE

OCEAN BLACK FIN

The black coating with enhanced epoxy resin is applied on the heat exchanger for strong protection from various corrosive external conditions such as salt contamination and air pollution.

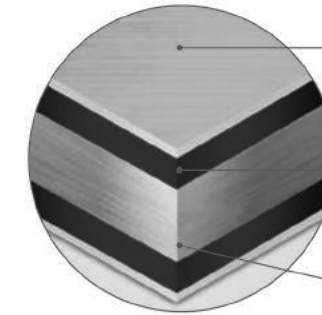

- Hydrophilic film (Water flow)**
The Hydrophilic coating minimizes moisture buildup on the fin.
- Epoxy resin (Corrosion resistant)**
The Black coating provides strong protection from corrosion.
- Aluminum fin**



* Tested by Method B
 (Test condition: Salt contaminated condition + severe industrial / traffic environment (NO₂ / SO₂))

Condition of salt spray test

Temperature	35°C
Mist of 5% NaCl (mass fraction) solution	

Condition of gas exposure test

Temp.	Relative Humidity	Gas Volume Fraction	
		NO ₂	SO ₂
25°C	95%	10 x 10 ⁻⁶	5 x 10 ⁻⁶

Applicable product list

HP	Applicable product	Outdoor Unit model
4 HP	Ceiling Suspended	AUUQ40GH4
5 HP	Ceiling Suspended	AUUQ50GH4
6 HP	Ceiling Suspended, 4Way Cassette	AUUQ60GH4
6 HP	Floor Standing	APUQ60GT3E4

CEILING MOUNTED CASSETTE



COMPACT SIZE

Slim & compact design not only saves space but also reduces installation costs. It's designed to suit most of building designs and fit into various spaces.

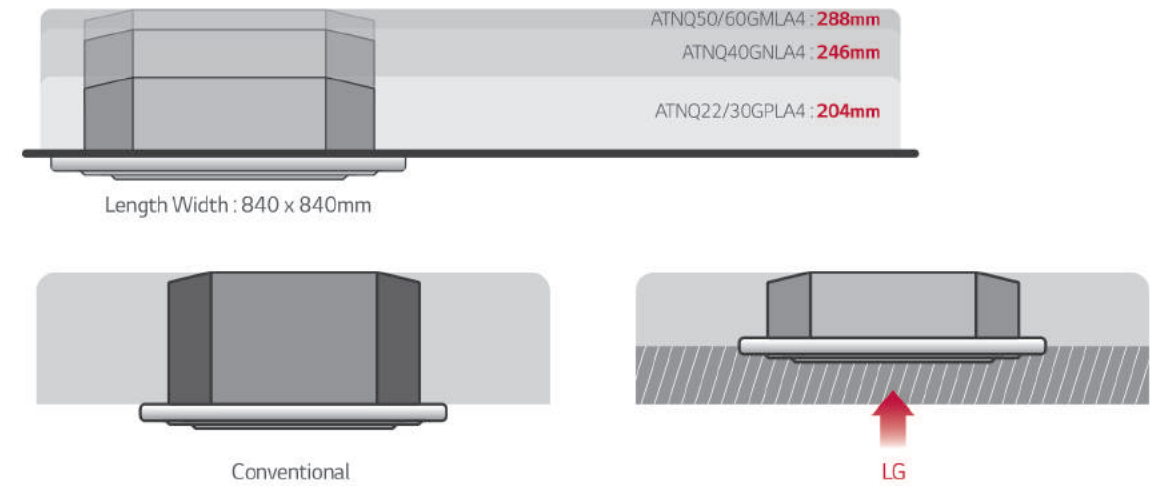

HIGH CEILING MODE

Airflow in a space with a 4.2m ceiling height is possible with this indoor unit. Further, air flow can be strengthened by adjusting the fan speed.

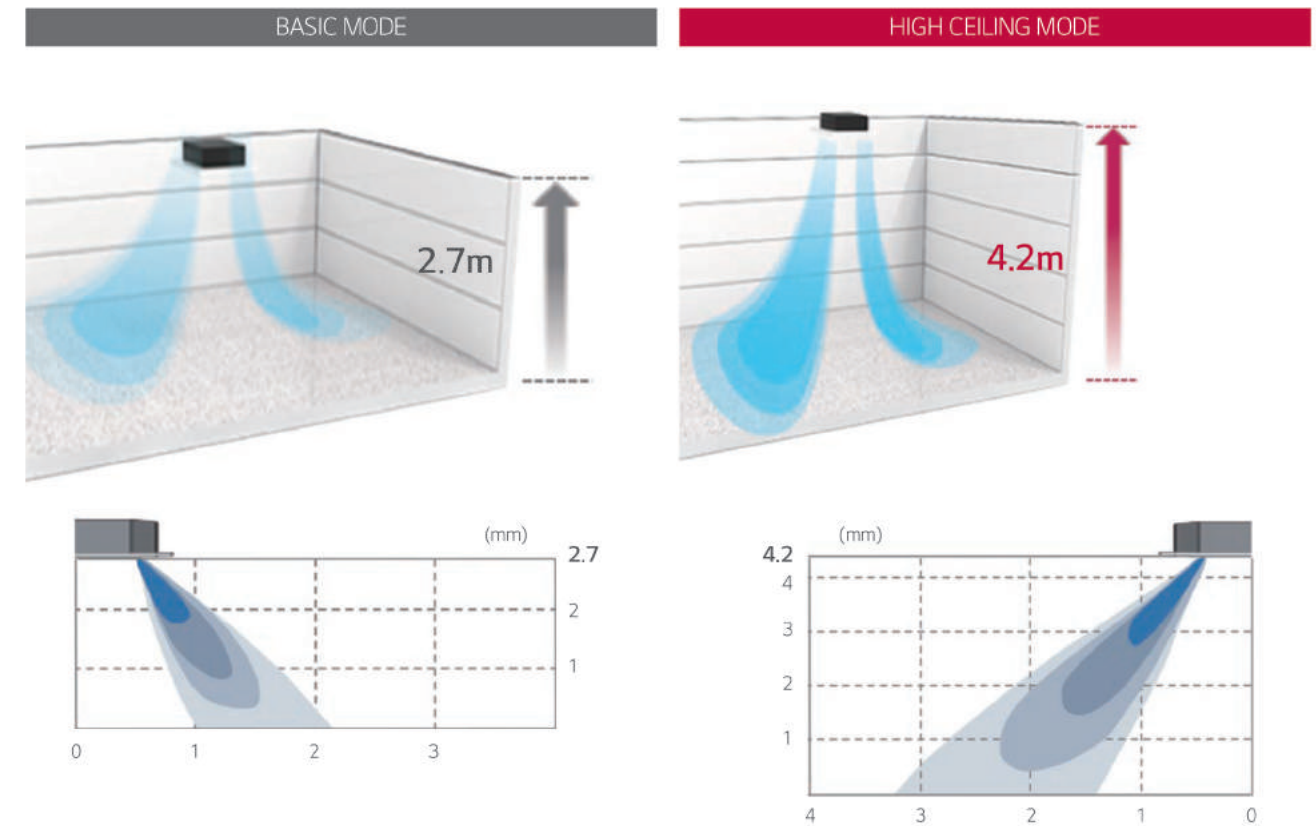

STYLISH DESIGN PANEL

New 4 way cassette panel adapted a unibody shape that matches with the ceiling.

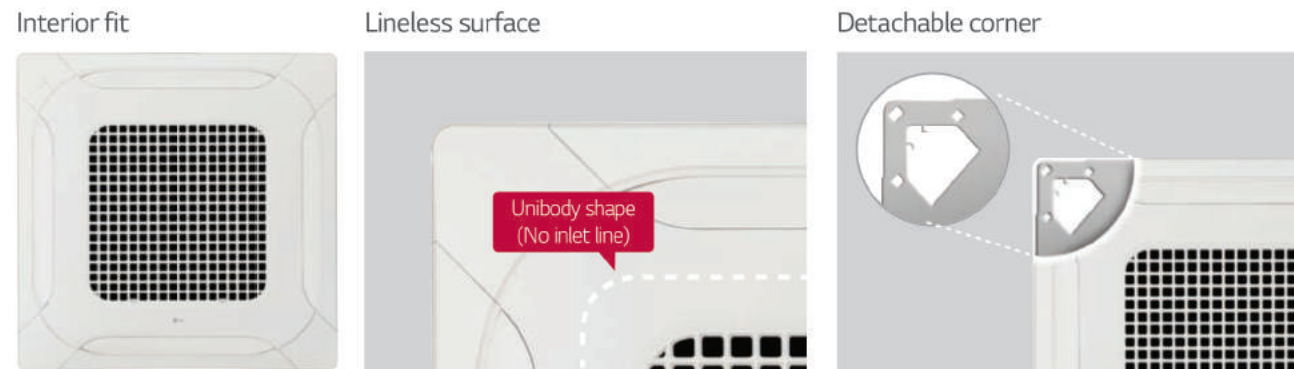

※ Old Panel : PT-UMC1 / New Panel : PT-MCHW0

CEILING MOUNTED CASSETTE

CONVENIENT PANEL INSTALLATION

The detachable corner design makes it easy to adjust the hanger during installation and to check for leakages in the drain connection pipe. And it is easy to install the panel to the body, using the button type panel design.

Detachable Corner Design

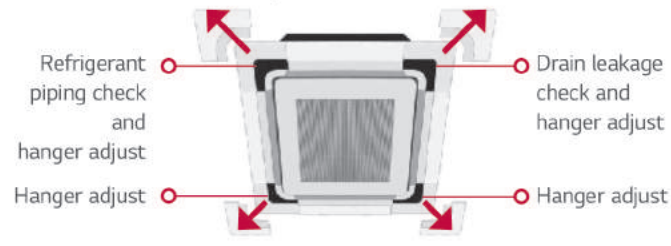

Drain Leakage Check

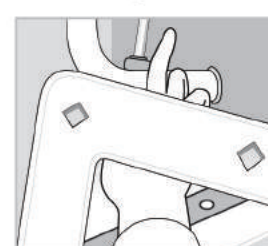

Hanger Adjust

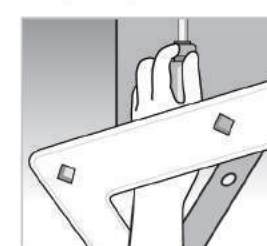

It is easy to install the panel to the body, using the button type panel design.

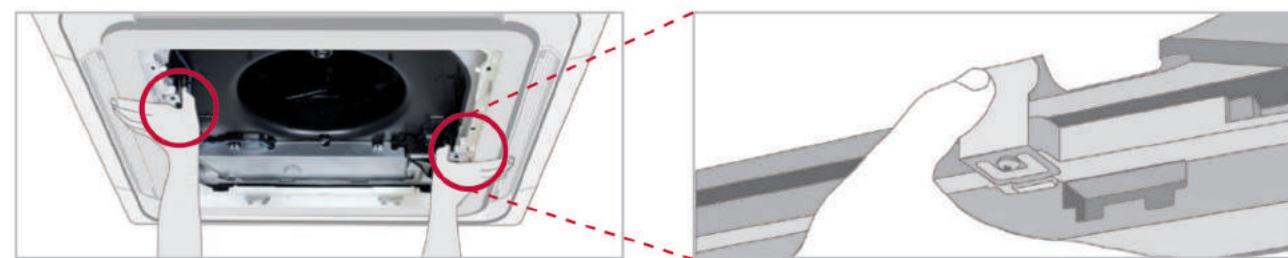

INDEPENDENT CONTROL OF AIRFLOW

The independent vane operation feature uses separate 4 motors, making it possible to control all four vanes independently. The independent control provides optimal comfort for each user. It is capable of handling inclination angles between 20° ~ 70°

Indirect air flow



Direct air flow

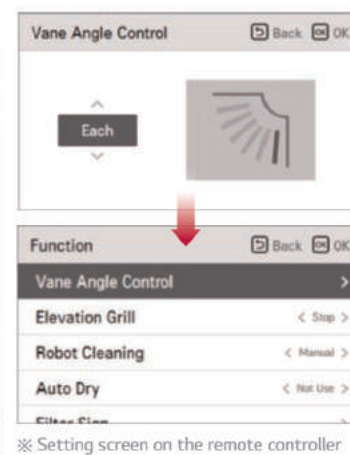

※ Setting screen on the remote controller



2-vane Control



1-vane Control



Volume Control



Angle Control

HUMAN DETECTION SENSOR & HUMIDITY SENSOR



Human detection sensor (PTVSM00)

Apply human detection sensor
Apply vision sensor
- Saving energy
- Supply comfortable air flow
- The sensor is an optional accessory that can only be applied on PT-MCGW0 (Cassette Panel)



※ Sensor is optional accessory (PTVSM00) : only can be applied to PT-MCGW0 (Cassette Panel)

※ To use this function, new remote controller, PREMTB100 or PREMTBB10 is needed

Detection

Motion sensors detect the activity of people per 10seconds.



Detection range



Height 3.2 (15 x 8m)

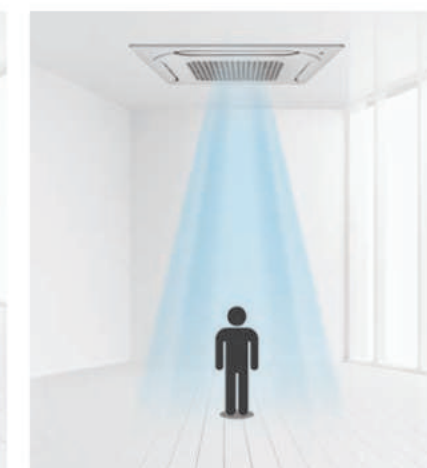

Height 3.5 (16 x 10m)



A sensor is installed 90° rotation
12 x 6m → 6 x 12m detecting

SPECIFICATIONS

CEILING MOUNTED CASSETTE



* Wireless Remote Controller Included

Set Condition				2.5 HP / 2.0 TR	4.0 HP / 3.2 TR
Capacity	Cooling	Max / Rated / Min	Btu/h	26,200-24,000-7,200	39,400-36,000-10,800
		Max / Rated / Min	kW	7.68-7.00-2.11	11.55-10.6-3.15
Power Input	Cooling	Rated	kW	2.17	3.5
Running Current	Cooling	Rated	A	9.5	15.1
EER			w/w	3.24	3.01
Indoor Unit				ATNQ24GPLE7	ATNQ36GNLE7
Power Supply	V, Ø, Hz	Rated	kW	220-240, 1, 50/60	220-240, 1, 50/60
Air Flow Rate	Cooling	H / M / L	m ³ /min	18.0 / 16.0 / 14.0	23.0 / 21.0 / 19.0
CMH (m ³ /h)	Cooling	H / M / L	m ³ /min	1080 / 960 / 840	1380 / 1260 / 1140
LPS (L/S)	Cooling	H / M / L	m ³ /min	530 / 267 / 233	383 / 350 / 317
Sound Pressure	Cooling	H / M / L	dB(A)	40 / 38 / 36	42 / 40 / 38
Dimension	Body	W x H x D	mm	840 x 204 x 840	840 x 246 x 840
Net Weight			kg (lbs)	19.7 (43.4)	23.3 (51.4)
Piping connection	Liquid		mm (in.)	φ 9.52 (3/8)	φ 9.52 (3/8)
	Gas		mm (in.)	φ 15.88 (5/8)	φ 15.88 (5/8)
	Drain (O.D. / I.D.)		mm	φ 32.0 / 25.0	φ 32.0 / 25.0
Decoration Panel	Model Name			PT-MCGW0	PT-MCGW0
	Dimension	W x H x D	mm	950 x 35 x 950	950 x 35 x 950
	Net Weight		kg (lbs)	6.3	6.3
Outdoor Unit				ATUQ24GPLE7	AUUQ36GH4
Power Supply	V, Ø, Hz	Rated	kW	220-240, 1, 50/60	220-240, 1, 50/60
Compressor			Type	LG Inverter Twin Rotary	LG R1 Inverter Scroll
			Motor	BLDC	BLDC
Fan			Type	Propeller	Propeller
			Motor	BLDC	BLDC
Sound Pressure	Cooling	H / M / L	dB(A)	53	55
Dimension	Body	W x H x D	mm	870 x 650 x 330	950 x 834 x 330
Net Weight			kg (lbs)	41.5 (91.5)	55.0 (121.3)
Piping Length	Total Length		m	50	50
	Elevation difference		m	30	30
Piping Connection	Liquid	Outer Dia.	mm (in.)	φ 9.52 (3/8)	φ 9.52 (3/8)
	Gas	Outer Dia.	mm (in.)	φ 15.88 (5/8)	φ 15.88 (5/8)
Operation Range	Cooling		°C	-5 ~ 46 °C	-5 ~ 46 °C

[All data are based on the following conditions]

※ Cooling Temperature : Indoor 27°C(80.6°F) DB / 19°C(66.2°F) WB, Outdoor 35°C(95°F) DB / 24°C(75.2°F) WB

※ Wiring cable size must comply with the applicable local and national codes.

※ Due to our policy of innovation some specifications may be changed without notifications.

※ Sound Level Values are measured at Anechoic chamber.

Therefore, these values can be increased owing to ambient conditions during operation.



Set Condition				5.0 HP / 4.0 TR	6.0 HP / 4.8 TR
Capacity	Cooling	Max / Rated / Min	Btu/h	49,500-46,000-13,800	61,000-58,000-13,800
		Max / Rated / Min	kW	14.5-13.5-4.05	17.88-17.00-4.05
Power Input	Cooling	Rated	kW	4.49	5.85
Running Current	Cooling	Rated	A	19.5	25.7
EER			w/w	3.01	2.91
Indoor Unit				ATNQ48GMLE7	ATNQ60GMLA4
Power Supply	V, Ø, Hz	Rated	kW	220-240, 1, 50/60	220-240, 1, 50/60
Air Flow Rate	Cooling	H / M / L	m ³ /min	32.0 / 30.0 / 28.0	31.0 / 28.0 / 25.0
CMH (m ³ /h)	Cooling	H / M / L	m ³ /min	1920 / 1800 / 1680	1860 / 1680 / 1500
LPS (L/S)	Cooling	H / M / L	m ³ /min	533 / 500 / 466	516 / 466 / 416
Sound Pressure	Cooling	H / M / L	dB(A)	44 / 42 / 40	47 / 45 / 42
Dimension	Body	W x H x D	mm	840 x 288 x 840	840 x 288 x 840
Net Weight			kg (lbs)	25.5 (56.2)	28 (61.7)
Piping connection	Liquid		mm (in.)	φ 9.52 (3/8)	φ 9.52 (3/8)
	Gas		mm (in.)	φ 15.88 (5/8)	φ 19.05 (3/4)
	Drain (O.D. / I.D.)		mm	φ 32.0 / 25.0	φ 32.0 / 25.0
Decoration Panel	Model Name			PT-MCGW0	PT-MCGW0
	Dimension	W x H x D	mm	950 x 35 x 950	950 x 35 x 950
	Net Weight		kg (lbs)	6.3	6.3
Outdoor Unit				AUUQ48GH4	AUUQ60GH4
Power Supply	V, Ø, Hz	Rated	kW	220-240, 1, 50/60	220-240, 1, 50/60
Compressor			Type	LG R1 Inverter Scroll	LG R1 Inverter Scroll
			Motor	BLDC	BLDC
Fan			Type	Propeller	Propeller
			Motor	BLDC	BLDC
Sound Pressure	Cooling	H / M / L	dB(A)	57	59
Dimension	Body	W x H x D	mm	950 x 834 x 330	950 x 1,380 x 330
Net Weight			kg (lbs)	58.0 (127.9)	83 (182.9)
Piping Length	Total Length		m	50	50
	Elevation difference		m	30	30
Piping Connection	Liquid	Outer Dia.	mm (in.)	φ 9.52 (3/8)	φ 9.52 (3/8)
	Gas	Outer Dia.	mm (in.)	φ 15.88 (5/8)	φ 19.05 (3/4)
Operation Range	Cooling		°C	-5 ~ 46 °C	-5 ~ 48 °C

[All data are based on the following conditions]

※ Cooling Temperature : Indoor 27°C(80.6°F) DB / 19°C(66.2°F) WB, Outdoor 35°C(95°F) DB / 24°C(75.2°F) WB

※ Wiring cable size must comply with the applicable local and national codes.

※ Due to our policy of innovation some specifications may be changed without notifications.

※ Sound Level Values are measured at Anechoic chamber.

Therefore, these values can be increased owing to ambient conditions during operation.

1Way CEILING CASSETTE



REDDOT AWARD WINNING DESIGN ENHANCES LUXURY HOUSE INTERIOR

Compact and Round shaped Panel brings excellent fit to ceiling



reddot award winner



4WAY AIR BLOW AUTO CONTROL

Auto Up/ Down/ Left/ Right control provides even Air Distribution

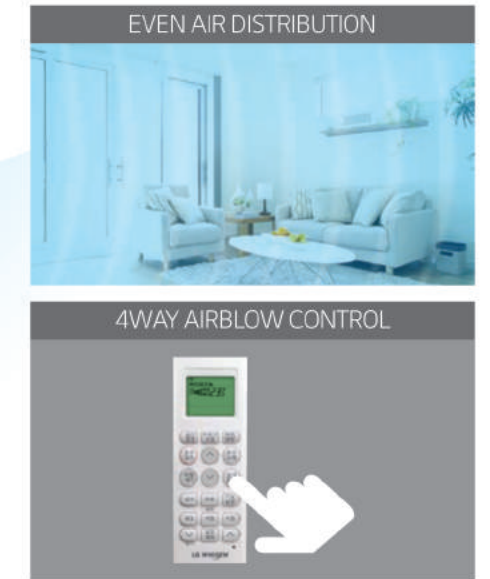

COMFORT COOLING (DIRECT/ INDIRECT WIND)

By selecting the Wind direction, User can easily achieve the preferred cooling comfort.



SLIM & COMPACT INDOOR UNIT

Slim indoor provides flexibility of installation in the narrow ceiling space

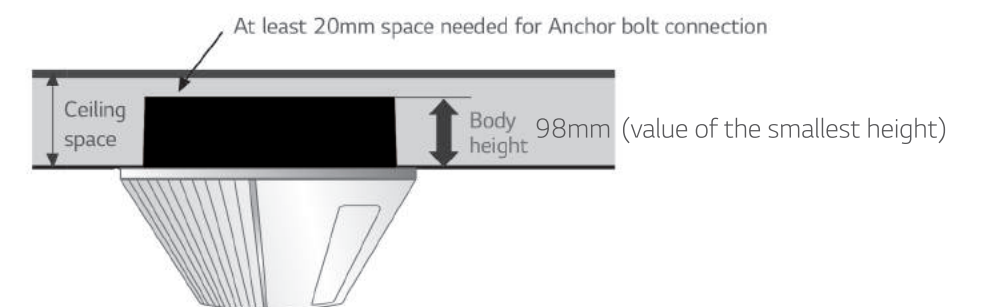

SPECIFICATIONS

1WAY CEILING CASSETTE



Set Condition				1.5 HP / 1.2 TR	2.0 HP / 1.6 TR
Capacity	Cooling	Max / Rated / Min	Btu/h	12,290-10,230-4,670	19,460-16,700-7,000
		Max / Rated / Min	kW	3.60-3.00-1.37	5.70-4.90-2.05
Power Input	Cooling	Rated	kW	0.99	1.52
Running Current	Cooling	Rated	A	4.6	7
EER			w/w	3.03	3.22
Indoor Unit				ATNQ12GULA1	ATNQ18GTLA1
Power Supply	V, ϕ , Hz	Rated	kW	220-240, 1, 50/60	220-240, 1, 50/60
Air Flow Rate	Cooling	H / M / L	m ³ /min	90 / 80 / 70	160 / 140 / 120
CMH (m ³ /h)	Cooling	H / M / L	m ³ /min	540 / 480 / 420	960 / 840 / 720
LPS (L/S)	Cooling	H / M / L	m ³ /min	150 / 133 / 117	267 / 233 / 200
Sound Pressure	Cooling	H / M / L	dB(A)	37 / 36 / 33	44 / 41 / 39
Dimension	Body	W x H x D	mm	860 x 132 x 450	1,180 x 132 x 450
Net Weight			kg	11.8	14.5
Piping connection	Liquid		mm (in.)	ϕ 6.35 (1/4)	ϕ 6.35 (1/4)
	Gas		mm (in.)	ϕ 9.52 (3/8)	ϕ 12.7 (1/2)
	Drain (O.D. / I.D.)		mm	ϕ 32.0 / 25.0	ϕ 32.0 / 25.0
Decoration Panel	Model Name			PT-UAHW0	PT-TAHW0
	Dimension	W x H x D	mm	1,100 x 34 x 500	1,420 x 34 x 500
	Net Weight		kg (lbs)	3.3	4.5
Outdoor Unit				ATUQ12GULA1	ATUQ18GTLA1
Power Supply	V, ϕ , Hz	Rated	kW	220-240, 1, 50/60	220-240, 1, 50/60
Compressor			Type	LG Inverter Twin Rotary	LG Inverter Twin Rotary
			Motor	BLDC	BLDC
Fan			Type	Axial	Axial
			Motor	BLDC	BLDC
Sound Pressure	Cooling	H / M / L	dB(A)	47	47
Dimension	Body	W x H x D	mm	770 x 545 x 288	770 x 545 x 288
Net Weight			kg	29.4	36
Piping Length	Total Length		m	20	30
	Elevation difference		m	15	20
Piping Connection	Liquid	Outer Dia.	mm (in.)	ϕ 6.35 (1/4)	ϕ 6.35 (1/4)
	Gas	Outer Dia.	mm (in.)	ϕ 9.52 (3/8)	ϕ 12.7 (1/2)
Operation Range	Cooling		°C	-10 - 48 °C	-10 - 48 °C

[All data are based on the following conditions]

※ Cooling Temperature : Indoor 27°C(80.6°F) DB / 19°C(66.2°F) WB, Outdoor 35°C(95°F) DB / 24°C(75.2°F) WB

※ Wiring cable size must comply with the applicable local and national codes.

※ Due to our policy of innovation some specifications may be changed without notifications.

※ Sound Level Values are measured at Anechoic chamber.

Therefore, these values can be increased owing to ambient conditions during operation.

NOTE

FLOOR STANDING UNIT

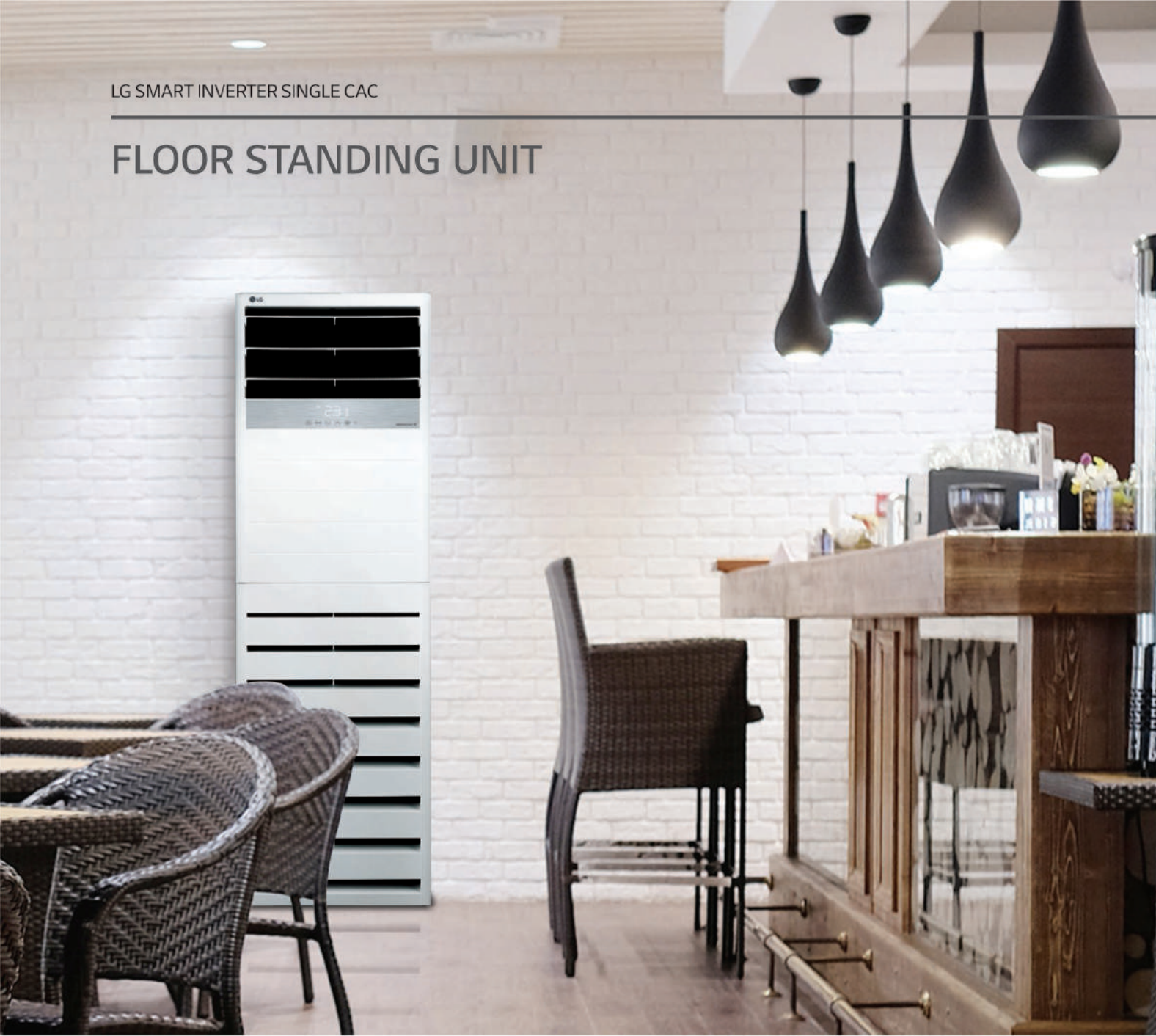

STYLISH DESIGN

The new LG floor standing air conditioner is ideal for modern interiors in your office or restaurant.



POWERFUL AIRFLOW

The new LG floor standing air conditioner is efficient for using in large areas due to its powerful cooling operation. The powerful air speed and volume means the air flow can reach up to 20m away from the air conditioner.



STRONG IN COOLING CAPACITY

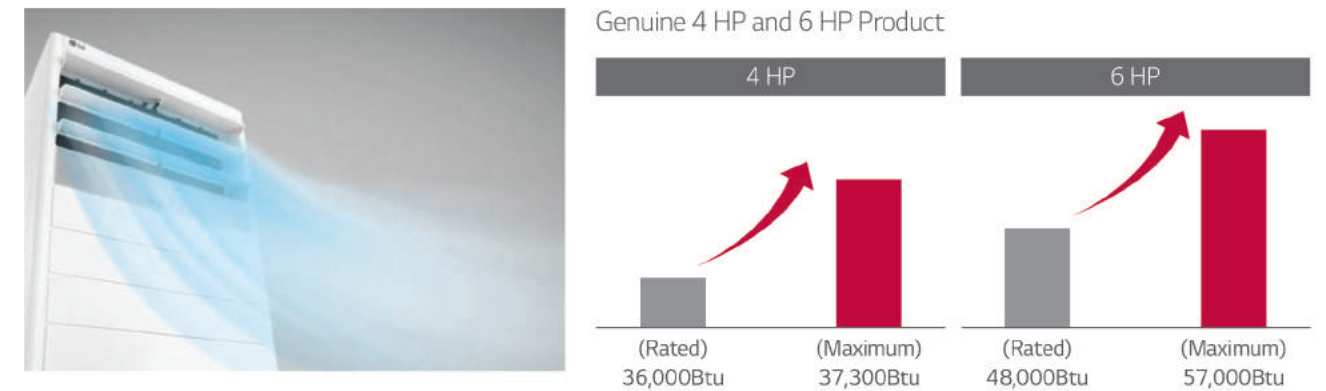

FLOOR STANDING UNIT

EXCELLENT COOLING PERFORMANCE

Power cooling function provides the optimal airflow angle, guaranteeing a faster and higher cooling performance.

Easy Power Cooling Mode



* Actual product appearance may differ from the above simulated scene.

Powerful & Even Air Distribution

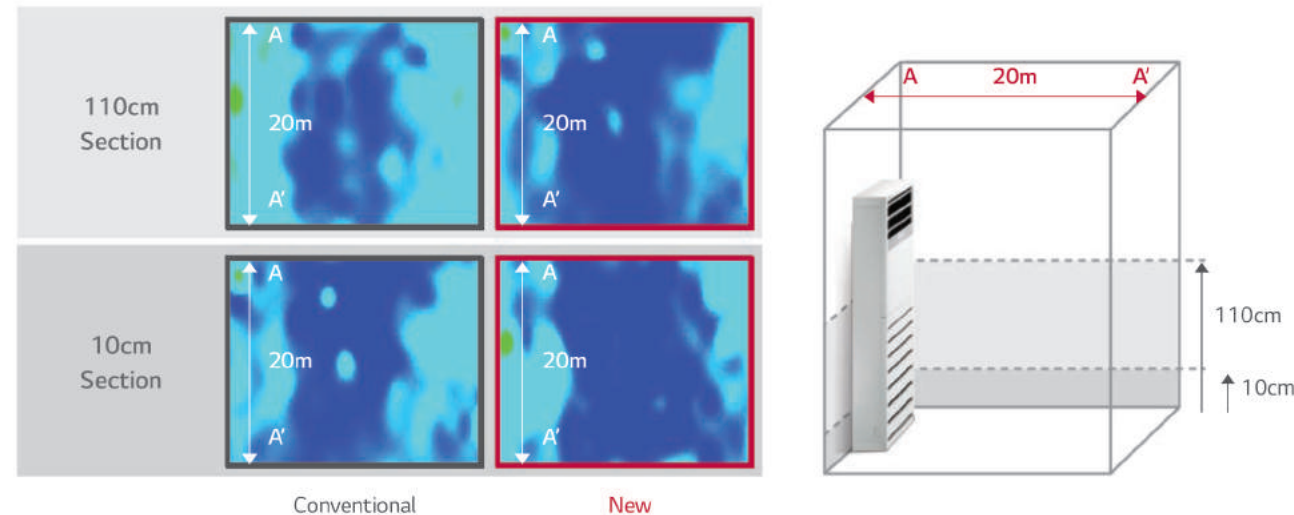

※ Indoor : 33°C → 24°C / Outdoor : 46°C

4WAY AUTO SWING (NEW FAN TECHNOLOGY)

Using new technology fan, LG provides strong Air flow rate and Low noise level.

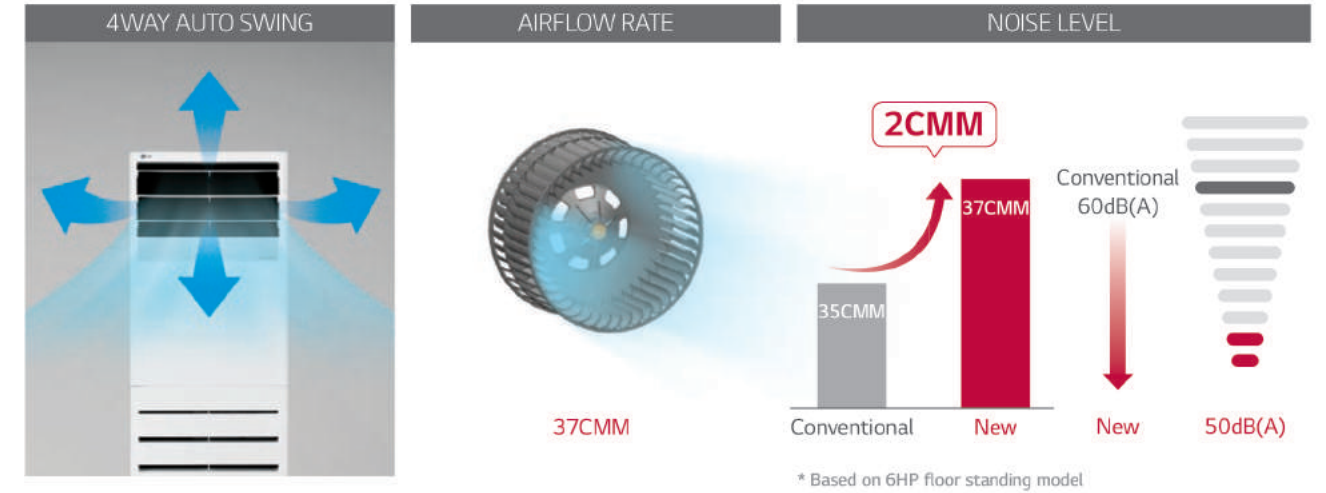

OCEAN BLACK FIN

The black coating with enhanced epoxy resin is applied on the heat exchanger for strong protection from various corrosive external conditions such as salt contamination and air pollution.

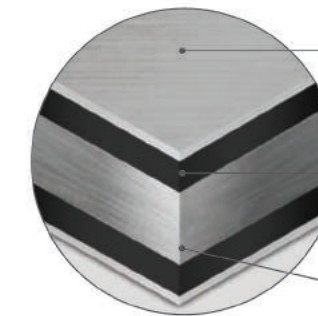

Hydrophilic film (Water flow)

The Hydrophilic coating minimizes moisture buildup on the fin.

Epoxy resin (Corrosion resistant)

The Black coating provides strong protection from corrosion.

Aluminum fin

Condition of salt spray test

Temperature	35°C
Mist of 5% NaCl (mass fraction) solution	

Condition of gas exposure test

Temp.	Relative Humidity	Gas Volume Fraction	
		NO ₂	SO ₂
25°C	95%	10 × 10 ⁻⁶	5 × 10 ⁻⁶



* Tested by Method B
(Test condition: Salt contaminated condition + severe industrial / traffic environment (NO₂ / SO₂))

* 'OCEAN BLACK FIN' is applicable to APUQ60GT3E4 model only

SPECIFICATIONS

FLOOR STANDING UNIT

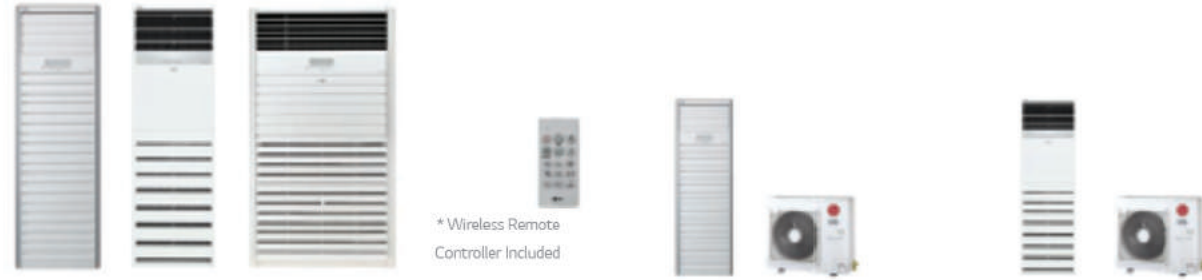

Set Condition				4.0 HP / 3.2 TR	5.0 HP / 4.0 TR
Capacity	Cooling	Max / Rated / Min	Btu/h	37,300-36,000-10,800	49,000-46,000-13,800
		Max / Rated / Min	kW	10.94-10.6-3.15	14.35-13.5-4.05
Power Input	Cooling	Rated	kW	3.5	4.49
Running Current	Cooling	Rated	A	15.1	19.5
EER			w/w	3.01	3.01
Indoor Unit				APNQ36GR5A4	APNQ48GT3E4
Power Supply	V, Ø, Hz	Rated	kW	220-240, 1, 50/60	220-240, 1, 50/60
Air Flow Rate	Cooling	SH / H / M / L	m ³ /min	23.5 / 19.0 / 17.0 / 14.0	37.0 / 33.0 / 28.0 / 24.0
CMH (m ³ /h)	Cooling	H / M / L	m ³ /min	1410 / 1140 / 1020 / 840	2220 / 1980 / 1680 / 1440
LPS (L/S)	Cooling	H / M / L	m ³ /min	392 / 316 / 283 / 233	616 / 550 / 487 / 400
Sound Pressure	Cooling	SH / H / M / L	dB(A)	52 / 47 / 44 / 41	53 / 50 / 47 / 45
Dimension	Body	W x H x D	mm	590 x 1,840 x 300	590 x 1,840 x 440
Net Weight			kg (lbs)	36.0 (79.4)	49.0 (108.0)
Piping connection	Liquid		mm (in.)	Φ 9.52 (3/8)	Φ 9.52 (3/8)
	Gas		mm (in.)	Φ 15.88 (5/8)	Φ 15.88 (5/8)
	Drain (O.D. / I.D.)		mm	Φ 21.0 / 17.0	Φ 21.0 / 17.0
Outdoor Unit				AUUQ36GH4	AUUQ48GH4
Power Supply	V, Ø, Hz	Rated	kW	220-240, 1, 50/60	220-240, 1, 50/60
Compressor			Type	LG R1 Inverter Scroll	LG R1 Inverter Scroll
			Motor	BLDC	BLDC
Fan			Type	Propeller	Propeller
			Motor	BLDC	BLDC
Sound Pressure	Cooling	H / M / L	dB(A)	55	57
Dimension	Body	W x H x D	mm	950 x 834 x 330	950 x 834 x 330
Net Weight			kg (lbs)	55.0 (121.3)	58.0 (127.9)
Piping Length	Total Length		m	50	50
	Elevation difference		m	30	30
Piping Connection	Liquid	Outer Dia.	mm (in.)	Φ 9.52 (3/8)	Φ 9.52 (3/8)
	Gas	Outer Dia.	mm (in.)	Φ 15.88 (5/8)	Φ 15.88 (5/8)
Operation Range	Cooling		ℓ	-5 ~ 46 ℓ	-5 ~ 46 ℓ

[All data are based on the following conditions]
 ℓ Cooling Temperature : Indoor 27°C(80.6°F) DB / 19°C(66.2°F) WB, Outdoor 35°C(95°F) DB / 24°C(75.2°F) WB
 ℓ Wiring cable size must comply with the applicable local and national codes.
 ℓ Due to our policy of innovation some specifications may be changed without notifications.
 ℓ Sound Level Values are measured at Anechoic chamber.
 Therefore, these values can be increased owing to ambient conditions during operation.



Set Condition				6.0 HP / 4.8 TR	10 HP / 8 TR
Capacity	Cooling	Max / Rated / Min	Btu/h	57,000-48,000-15,356	98,000-48,000
		Max / Rated / Min	kW	16.69-14.06-4.50	28.7-14.3
Power Input	Cooling	Rated	kW	4.00	11.5
Running Current	Cooling	Rated	A	18.2	19.5
EER			w/w	3.30	2.50
Indoor Unit				APNQ60GT3E4	APNQ100LFA0
Power Supply	V, Ø, Hz	Rated	kW	220-240, 1, 50/60	220-240, 1, 50/60
Air Flow Rate	Cooling	SH / H / M / L	m ³ /min	37.0 / 33.0 / 28.0 / 24.0	68 / 61 / - / 50
CMH (m ³ /h)	Cooling	H / M / L	m ³ /min	2220 / 1980 / 1680 / 1440	4080 / 3660 / 3000
LPS (L/S)	Cooling	H / M / L	m ³ /min	616 / 550 / 466 / 400	1133 / 1018 / 833
Sound Pressure	Cooling	SH / H / M / L	dB(A)	53 / 50 / 47 / 45	58 / 55 / - / 51
Dimension	Body	W x H x D	mm	590 x 1,840 x 440	1,050 x 1,880 x 495
Net Weight			kg (lbs)	49.0 (108.0)	113.0 (249.0)
Piping connection	Liquid		mm (in.)	Φ 9.52 (3/8)	Φ 9.52 (3/8)
	Gas		mm (in.)	Φ 19.05 (3/4)	Φ 22.2(7/8)
	Drain (O.D. / I.D.)		mm	Φ 21.0 / 17.0	Φ 32 / 25
Outdoor Unit				APUQ60GT3E4	APUQ100LFA0
Power Supply	V, Ø, Hz	Rated	kW	220-240, 1, 50/60	380-415, 3, 50/60
Compressor			Type	LG R1 Inverter Scroll	LG Inverter Scroll
			Motor	BLDC	BLDC
Fan			Type	Propeller	Propeller
			Motor	BLDC	BLDC
Sound Pressure	Cooling	H / M / L	dB(A)	59	58
Dimension	Body	W x H x D	mm	950 x 1,380 x 330	1,090 x 1,625 x 380
Net Weight			kg (lbs)	83 (182.9)	143.0 (315)
Piping Length	Total Length		m	50	50
	Elevation difference		m	30	30
Piping Connection	Liquid	Outer Dia.	mm (in.)	Φ 9.52 (3/8)	Φ 9.52 (3/8)
	Gas	Outer Dia.	mm (in.)	Φ 19.05 (3/4)	Φ 22.2(7/8)
Operation Range	Cooling		ℓ	-15 ~ 48 ℓ	-10 ~ 48 ℓ

[All data are based on the following conditions]
 ℓ Cooling Temperature : Indoor 27°C(80.6°F) DB / 19°C(66.2°F) WB, Outdoor 35°C(95°F) DB / 24°C(75.2°F) WB
 ℓ Wiring cable size must comply with the applicable local and national codes.
 ℓ Due to our policy of innovation some specifications may be changed without notifications.
 ℓ Sound Level Values are measured at Anechoic chamber.
 Therefore, these values can be increased owing to ambient conditions during operation.

SPECIFICATIONS

Floor Standing Unit



Indoor Unit				15 HP / 12 TR	20 HP / 16 TR
				APNQ150LNA0	APNQ200LNA0
Power Supply	V, Ø, Hz			220-240, 1, 50	220-240, 1, 50
Power Input	W			660	830
Running Current	A			3.0	3.8
Casing Color	-			-	-
Dimensions	Body	W x H x D	mm	1,558 x 1,920 x 700	1,558 x 1,920 x 700
		W x H x D	inch	61-11/32 x 75-19/32 x 27-9/16	61-11/32 x 75-19/32 x 27-9/16
Net Weight	Body		kg (lbs)	237.0 (522.5)	237.0 (522.5)
Heat Exchanger	(Row x Column x Fins per inch) x No.		-	(4 x 34 x 21) x 1	(4 x 34 x 21) x 1
	Face Area		m ² (ft. ²)	0.98 (10.54)	0.98 (10.54)
Fan	Type			Sirocco Fan	Sirocco Fan
	Air Flow Rate	H / L	m ³ / min	120.0 / 95.0	130.0 / 95.0
		H / L	ft ³ / min	4,238 / 3,355	4,591 / 3,355
	CMH	H / L		7200 / 5700	7800 / 5700
Fan Motor	Type			BLDC	BLDC
	Output	W x No.		750 x 2	750 x 2
Sound Pressure Level		H / L	dB(A)	64 / 57	65 / 57
Sound Power Level		Max.	dB(A)	-	-
Piping Connections	Liquid		mm(inch)	Ø 15.88 (5/8)	Ø 15.88 (5/8)
	Gas		mm(inch)	Ø 28.58 (1-1/8)	Ø 28.58 (1-1/8)
	Drain (O.D. / I.D.)		mm	Ø 21.0 / 17.0	Ø 21.0 / 17.0
Safety Devices				Fuse	Fuse
Communication Cable				Thermal Protector for Fan Motor	
Power Cable (Included Earth)				2C x 1.0-1.5 (H07RN-F)	3C x 2.5 (H07RN-F)
Outdoor Unit				APNQ150LNA0	APNQ200LNA0
Capacity	Cooling	Min.-Rated	kW	18.8 - 46.9	23.4 - 58.6
		Min.-Rated	Btu/h	64,200 - 160,000	79,900 - 200,000
	Heating	Min.-Rated	kW	-	-
		Min.-Rated	Btu/h	-	-
Power Input	Cooling	Rated	kW	16.1	21.0
	Heating	Rated	kW	-	-
Running Current	Cooling	Rated	A	22.0	28.2
	Heating	Rated	A	-	-
Power Supply	V, Ø, Hz			380-415, 3, 50	380-415, 3, 50
Starting Current	Cooling	Max.	A	-	-
	Heating	Max.	A	-	-
Wiring Connections	Power Supply Cable (included Earth)		No. x mm ² (AWG)	5C x 6.0 (10)	5C x 6.0 (10)
Casing Color				Warm Gray /Morning Gray	Warm Gray /Morning Gray
Dimensions		W x H x D	mm	1,240 x 1,680 x 760	1,240 x 1,680 x 760
		W x H x D	inch	48-13/16 x 66-5/32 x 29-29/32	48-13/16 x 66-5/32 x 29-29/32
Net Weight			kg (lbs)	270.0 (595.2)	270.0 (595.2)
Compressor	Type			Hermetic Motor Compressor	Hermetic Motor Compressor
	Model	Model x No.		JQA048MAC x 2	JQA048MAC x 2
	Motor type			BLDC	BLDC
	Motor Output	W x No.		4,200 x 2	4,200 x 2
Refrigerant	Type			R410A	R410A
	Precharged Amount		g (oz)	10,000 (352.7)	10,000 (352.7)
	Chargeless-Pipe Length		m (ft)	5.0 (16.4)	5.0 (16.4)
	Additional Charging Volume		g/m (oz/ft)	150 (1.61)	150 (1.61)
	Control			Electronic Expansion Valve	Electronic Expansion Valve
Refrigerant Oil	Type			FVC68D(PVE)	FVC68D(PVE)
	Charged volume	cc x No.		3,600 x 2	3,600 x 2
Heat Exchanger	(Row x Column x Fins per inch) x No.		-	(2 x 58 x 14) x 1	(2 x 58 x 14) x 1
Fan	Type			Propeller	Propeller
	Air Flow Rate			290	290
Fan Motor	Type			BLDC	BLDC
	Output	W x No.		900.0 x 2	900.0 x 2
Sound Pressure Level	Cooling	Rated	dB(A)	64	65
	Heating	Rated	dB(A)	-	-
Sound Power Level		Max.	dB(A)	-	-
Piping Connections	Liquid	Outer Dia.	mm(inch)	Ø 15.88 (5/8)	Ø 15.88 (5/8)
	Gas	Outer Dia.	mm(inch)	Ø 28.58 (1-1/8)	Ø 28.58 (1-1/8)
Piping Length		Max.	m (ft)	50 (164.0)	50 (164.0)
Maximum Height Difference	Outdoor Unit - Indoor Unit	Max.	m (ft)	30 (98.4)	30 (98.4)
Operation Range (Outdoor Temperature)	Cooling	Min. - Max.	°CDB (°F DB)	-10 (14.0) - 48 (118.4)	-10 (14.0) - 48 (118.4)
	Heating	Min. - Max.	°CWB (°F WB)	-	-

NOTE

CEILING SUSPENDED UNIT



IF WINNING DESIGN

With its stunning V-shaped design and black vane, LG's new ceiling-suspended air conditioner exudes modern elegance appropriate for any space.

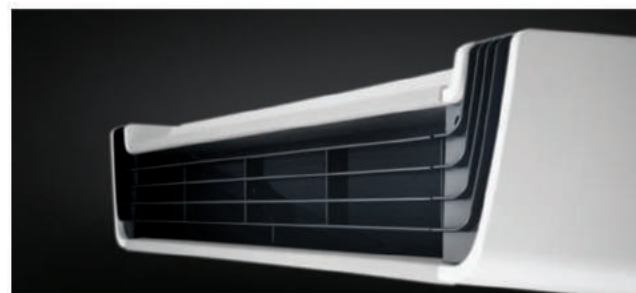

Black Vane

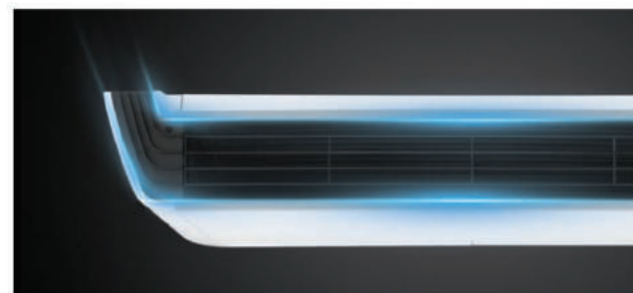

V-Shaped Design



LARGE CAPACITY

An enlarged outlet space optimized the air flow path and improved heat exchanger's performance. It's 30% faster cooling enable quick & wide cooling.

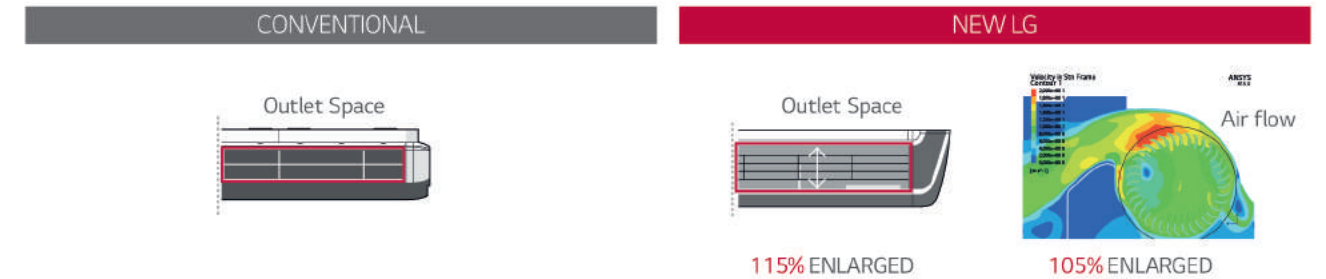

15M LONG AIR FLOW

The powerful air speed and high volume features enhance the flow of air to reach up to 15m away from the air conditioner.



ONE TOUCH FILTER CHANGING

An easy In/Out filter structure as well as a simplified two-piece filter, which slides out for easy cleaning and maintenance.

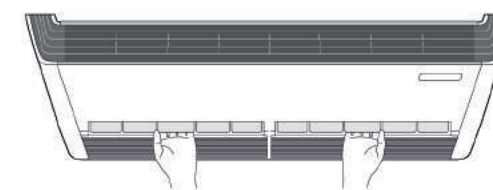

One Touch Filter

EASY INSTALLATION

Installation speed and ease are improved by reducing the total number of screws and placing them on the easily accessible front panel.

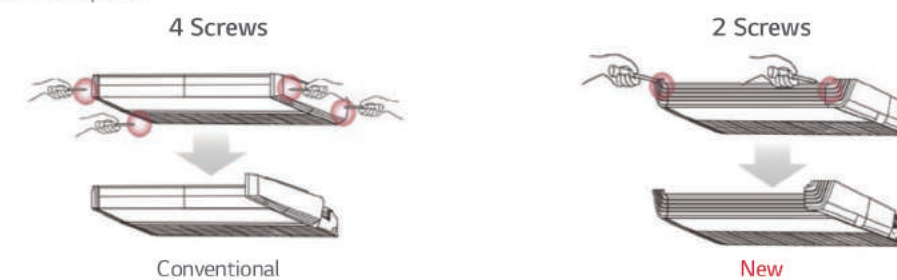

SPECIFICATIONS

CEILING SUSPENDED UNIT



* Wireless Remote Controller Included



Set Condition				4.0 HP / 3.2 TR
Capacity	Cooling	Max / Rated / Min	Btu/h	39,400-34,100-10,800
		Max / Rated / Min	kW	11.55-9.99-3.15
Power Input	Cooling	Rated	kW	3.22
Running Current	Cooling	Rated	A	14.1
EER			w/w	3.10
Indoor Unit				AVNQ40GM1A4
Power Supply	V, Ø, Hz	Rated	kW	220-240, 1, 50/60
Air Flow Rate	Cooling	H / M / L	m ³ /min	20.0 / 18.0 / 16.0
CMH (m ³ /h)	Cooling	H / M / L	m ³ /min	1200 / 1080 / 960
LPS (L/S)	Cooling	H / M / L	m ³ /min	333 / 300 / 266
Sound Pressure	Cooling	H / M / L	dB(A)	47 / 45 / 42
Dimension	Body	W x H x D	mm	1,200 x 235 x 690
Net Weight			kg	28
Piping connection	Liquid		mm (in.)	Φ 9.52 (3/8)
	Gas		mm (in.)	Φ 15.88 (5/8)
	Drain (O.D. / I.D.)		mm	Φ 21.5 / 16.0
Outdoor Unit				AUUQ40GH4
Power Supply	V, Ø, Hz	Rated	kW	220-240, 1, 50/60
Compressor			Type	LG R1 Inverter Scroll
			Motor	BLDC
Fan			Type	Propeller
			Motor	BLDC
Sound Pressure	Cooling	H / M / L	dB(A)	55
Dimension	Body	W x H x D	mm	950 x 834 x 330
Net Weight			kg	56
Piping Length		Total Length	m	50
		Elevation difference	m	30
Piping Connection	Liquid	Outer Dia.	mm (in.)	Φ 9.52 (3/8)
	Gas	Outer Dia.	mm (in.)	Φ 15.88 (5/8)
Operation Range		Cooling	°C	-5 - 48 °C

Set Condition				5.0 HP / 4.0 TR	6.0 HP / 4.8 TR
Capacity	Cooling	Max / Rated / Min	Btu/h	49,500-44,000-13,800	61,000-58,000-13,800
		Max / Rated / Min	kW	14.5-12.9-4.05	17.88-17.00-4.05
Power Input	Cooling	Rated	kW	4.53	5.85
Running Current	Cooling	Rated	A	19.9	25.7
EER			w/w	2.85	2.91
Indoor Unit				AVNQ50GM2A4	AVNQ60GM2A4
Power Supply	V, Ø, Hz	Rated	kW	220-240, 1, 50/60	220-240, 1, 50/60
Air Flow Rate	Cooling	H / M / L	m ³ /min	30.0 / 25.0 / 20.0	30.0 / 25.0 / 20.0
CMH (m ³ /h)	Cooling	H / M / L	m ³ /min	1800 / 1500 / 1200	1800 / 1500 / 1200
LPS (L/S)	Cooling	H / M / L	m ³ /min	500 / 416 / 303	500 / 416 / 1333
Sound Pressure	Cooling	H / M / L	dB(A)	48 / 44 / 40	48 / 44 / 40
Dimension	Body	W x H x D	mm	1,600 x 235 x 690	1,600 x 235 x 690
Net Weight			kg	35	35
Piping connection	Liquid		mm (in.)	Φ 9.52 (3/8)	Φ 9.52 (3/8)
	Gas		mm (in.)	Φ 15.88 (5/8)	Φ 19.05 (3/4)
	Drain (O.D. / I.D.)		mm	Φ 21.5 / 16.0	Φ 21.5 / 16.0
Outdoor Unit				AUUQ50GH4	AUUQ60GH4
Power Supply	V, Ø, Hz	Rated	kW	220-240, 1, 50/60	220-240, 1, 50/60
Compressor			Type	LG R1 Inverter Scroll	LG R1 Inverter Scroll
			Motor	BLDC	BLDC
Fan			Type	Propeller	Propeller
			Motor	BLDC	BLDC
Sound Pressure	Cooling	H / M / L	dB(A)	57	59
Dimension	Body	W x H x D	mm	950 x 834 x 330	950 x 1,380 x 330
Net Weight			kg	67	83
Piping Length		Total Length	m	50	50
		Elevation difference	m	30	30
Piping Connection	Liquid	Outer Dia.	mm (in.)	Φ 9.52 (3/8)	Φ 9.52 (3/8)
	Gas	Outer Dia.	mm (in.)	Φ 15.88 (5/8)	Φ 19.05 (3/4)
Operation Range		Cooling	°C	-5 - 48 °C	-5 - 48 °C

[All data are based on the following conditions]

※ Cooling Temperature : Indoor 27°C(80.6°F) DB / 19°C(66.2°F) WB, Outdoor 35°C(95°F) DB / 24°C(75.2°F) WB

※ Wiring cable size must comply with the applicable local and national codes.

※ Due to our policy of innovation some specifications may be changed without notifications.

※ Sound Level Values are measured at Anechoic chamber.

Therefore, these values can be increased owing to ambient conditions during operation.

[All data are based on the following conditions]

※ Cooling Temperature : Indoor 27°C(80.6°F) DB / 19°C(66.2°F) WB, Outdoor 35°C(95°F) DB / 24°C(75.2°F) WB

※ Wiring cable size must comply with the applicable local and national codes.

※ Due to our policy of innovation some specifications may be changed without notifications.

※ Sound Level Values are measured at Anechoic chamber.

Therefore, these values can be increased owing to ambient conditions during operation.

CEILING CONCEALED DUCT



MAXIMIZED E.S.P. (EXTERNAL STATIC PRESSURE)

With new indoor tool, connectable duct length is more longer than current running unit due to the maximum E.S.P. is improved. Noise level also decreased about 14%

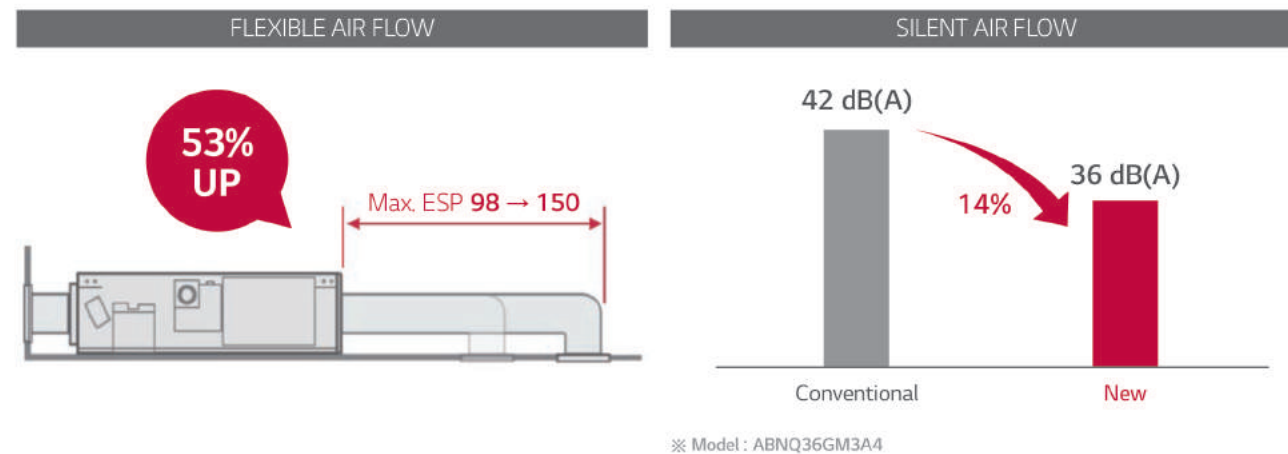

MINIMIZED HEIGHT

New mid-static ducts provide ideal solution for installation in limited space.

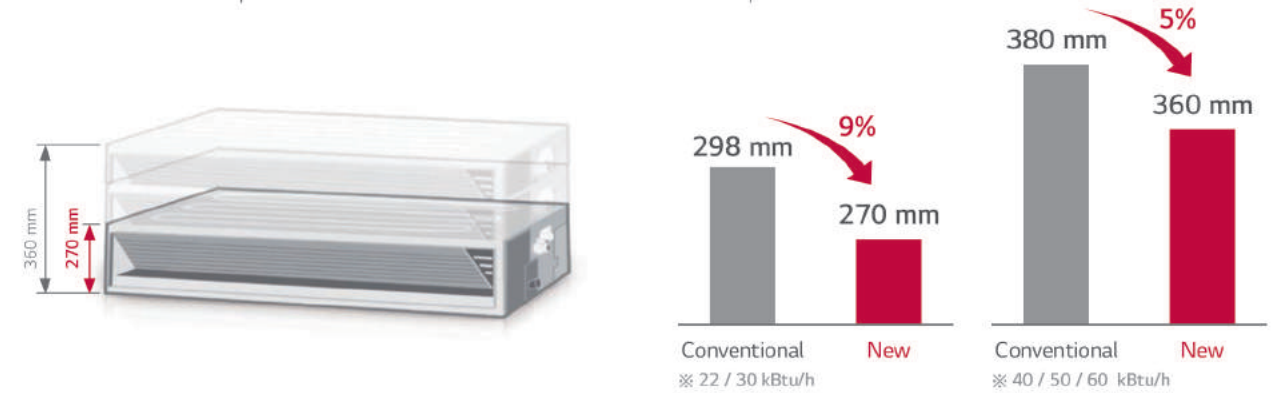

EASY SERVICE & MAINTENANCE

Users are not required to disassemble the whole panel for maintenance; since panel is divided into 2 components; one for heat exchanger and the other for fan/motor. The user can easily detach and re-attach the filter in the available limited space.

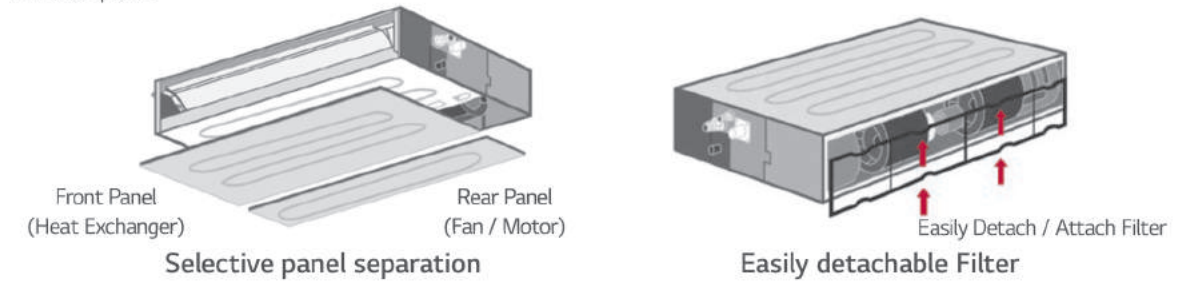

TWO THERMISTORS CONTROL

The indoor temperature can be checked using the thermistors in the remote controller as well as from the indoor unit. There may be a significant difference between ceiling and floor air temperature. Two thermistors can optimise indoor air temperature for a more comfortable environment.

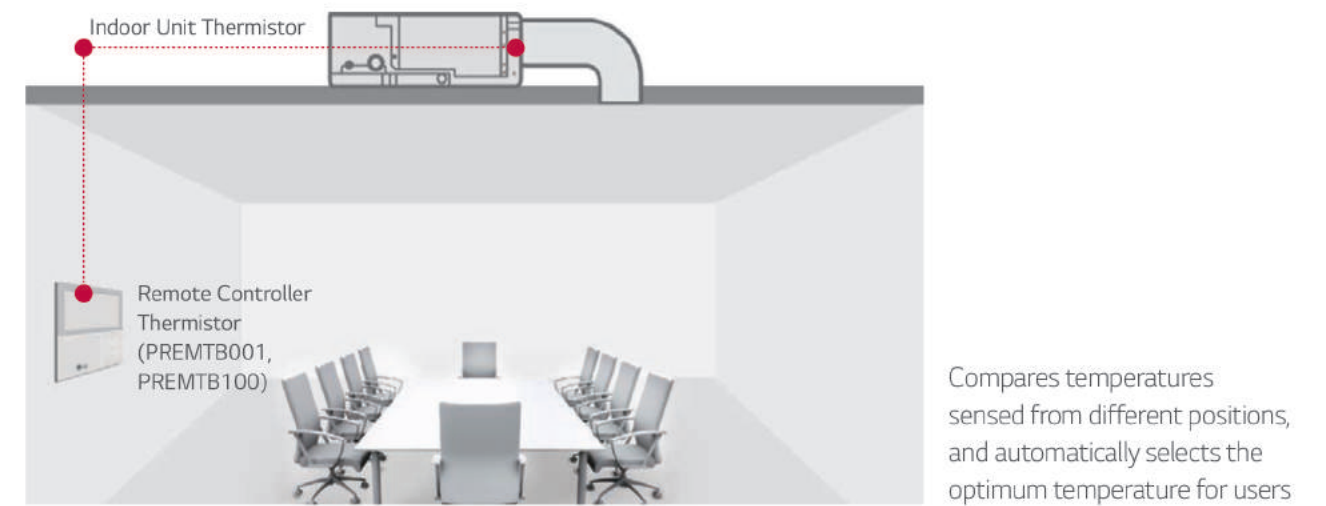

SPECIFICATIONS

CEILING CONCEALED



Low Static

* Wired Remote Controller Included



Mid Static

* Wired Remote Controller Included



Model Name		Unit	2.5 HP / 2.0 TR ABNQ22GM1A4	3.0 HP / 2.4 TR ABNQ30GM1A4
Capacity	Cooling Min.~ Rated ~ Max.	Btu/h	5,400 ~ 17,060 ~ 22,000	7,200 ~ 24,000 ~ 30,000
Power Supply	V, Φ, Hz		220-240, 1, 50/60	220-240, 1, 50/60
Indoor Fan	Type	-	Sirocco	Sirocco
	Air Flow Rate(H/M/L)	m ³ /min	16.5 / 14.5 / 13.0	18.0 / 16.5 / 14.5
	CMH	m ³ /min	990 / 870 / 780	1080 / 990 / 870
	LPS	L / S	275 / 241 / 216	300 / 275 / 241
	External Static Pressure_Factory Set (Default)	mmAq	6	6
	Pascal	pa	58 - 83 pa	58 - 83 pa
Indoor Fan Motor	Type	-	BLDC	BLDC
	Drive	-	-	-
	Output	W x No.	136.5 x 1	136.5 x 1
	FLA(Full Load Ampere)	A	1.6	1.6
Dehumidification Rate	-	l/h	1.5	2.5
Heat Exchanger	(Rows x Columns x FPI) x No.	-	(2 x 13 x 18) x 1	(3 x 13 x 18) x 1
	Face Area	m ² (ft ²)	0.21	0.21
Dimensions	Net(W x H x D)	mm	900 x 270 x 700	900 x 270 x 700
	Shipping(W x H x D)	mm	1,100 x 338 x 773	1,100 x 338 x 773
Weight	Net	kg	23.8	25.3
	Shipping	kg	29.1	30.3
Protection Device	-	-	Fuse	Fuse
Refrigerant	Control Type	-	EEV	EEV
Drain Pipe	O.D / I.D	mm	25.4 / 19.4	25.4 / 19.4
Piping Connection	Liquid	mm(inch)	6.35 (1/4)	9.52 (3/8)
	Gas	mm(inch)	12.7 (1/2)	15.88 (5/8)
Sound Pressure Level	Cooling(H/M/L)	dB(A)	34 / 32 / 30	37 / 35 / 32
Connecting Cable	Power and Communication cable(H07RN-F)	mm ² x cores	0.75 x 4	0.75 x 4
Model Name		Unit	ABUQ22GM1A4	ABUQ30GM1A4
Power Supply			220-240, 1, 50/60	220-240, 1, 50/60
Power Supply Cable (included Earth)	No. x mm2		3C x 2.5	3C x 2.5
Casing Color			Warm Gray	Warm Gray
Dimensions	Net	W x H x D	770 x 545 x 288	870 x 650 x 330
	Weight	Net, kg	33	41.5
Compressor	Type		Twin Rotary	Twin Rotary
	Model		GAT158MAD x 1	GKT208MAB x 1
	Motor type		BLDC	BLDC
	Motor Output		1,500 x 1	1,500 x 1
Refrigerant	Type		R410A	R410A
	GWP (Global Warming Potential)		-	-
	Precharged Amount, g (oz)		850 (30)	1100 (38.8)
	Control		Electronic Expansion Valve	Electronic Expansion Valve
	Chargeless-Pipe Length, m (ft)		7.5	7.5
	Additional Charging Volume, g/m		20	40
Refrigerant Oil	Type		RB68A	FVC68D
	Charged volume		400 x 1	670 x 1
Heat Exchanger	(Row x Column x FPI) x No.		(2 x 25 x 21) x 1	(2 x 30 x 21) x 1
Fan	Type		Propeller	Propeller
	Air Flow Rate	m ³ /min x No.	50 x 1	50 x 1
Fan Motor	Type		BLDC	BLDC
	Output	W x No.	43 x 1	85 x 1
Sound Pressure Level	Cooling	Rated dB(A)	47	53
Piping Connections	Liquid	Outer Dia.	Ø 6.35 (1/4)	Ø 9.52 (3/8)
	Gas	Outer Dia.	Ø 12.7 (1/2)	Ø 15.88 (5/8)
Piping Length		Min./Max. (m (ft.))	5/30	5/50
Maximum Height Difference (ODU - IDU)		Max. (m(ft.))	20	30

Model Name		Unit	4.0 HP ABNQ36GM3A4	5.0 HP ABNQ48GM3A4	6.0 HP ABNQ60GM3A4
Capacity	Cooling Min.~ Rated ~ Max.	Btu/h	10,800 ~ 36,000 ~ 39,400	13,800 ~ 46,000 ~ 49,000	13,800 ~ 60,100 ~ 61,000
Power Supply	V, Φ, Hz		220-240, 1, 50/60	220-240, 1, 50/60	220-240, 1, 50/60
Indoor Fan	Type	-	Sirocco	Sirocco	Sirocco
	Air Flow Rate(H/M/L)	m ³ /min	30.0 / 25.0 / 20.0	40.0 / 34.0 / 28.0	50.0 / 45.0 / 40.0
	CMH	m ³ /min	1800 / 1500 / 1200	2400 / 2040 / 1680	3000 / 2700 / 2400
	LPS	L / S	500 / 410 / 333	666 / 566 / 466	833 / 750 / 666
	External Static Pressure_Factory Set (Default)	mmAq	6	6	6
	Pascal	pa	58 - 83 pa	58 - 83 pa	58 - 83 pa
Indoor Fan Motor	Type	-	BLDC	BLDC	BLDC
	Drive	-	-	-	-
	Output	W x No.	154 x 1	400 x 1	400 x 1
	FLA(Full Load Ampere)	A	1.6	2.5	2.5
Dehumidification Rate	-	l/h	2.6	4.5	5
Heat Exchanger	(Rows x Columns x FPI) x No.	-	(3 x 16 x 18) x 1	(3 x 16 x 18) x 1	(3 x 16 x 18) x 1
	Face Area	m ² (ft ²)	0.36	0.36	0.36
Dimensions	Net(W x H x D)	mm	1,250 x 360 x 700	1,250 x 360 x 700	1,250 x 360 x 700
	Shipping(W x H x D)	mm	1,450 x 428 x 773	1,450 x 428 x 773	1,450 x 428 x 773
Weight	Net	kg	37.5	42.3	43.5
	Shipping	kg	45	51	51
Protection Device	-	-	Fuse	Fuse	Fuse
Refrigerant	Control Type	-	EEV	EEV	EEV
Drain Pipe	O.D / I.D	mm	32 / 25	32 / 25	32 / 25
Piping Connection	Liquid	mm(inch)	Ø 9.52(3/8)	Ø 9.52(3/8)	Ø 9.52 (3/8)
	Gas	mm(inch)	Ø 15.88(5/8)	Ø 15.88(5/8)	Ø 19.05 (3/4)
Sound Pressure Level	Cooling(H/M/L)	dB(A)	36 / 33 / 31	38 / 36 / 34	46 / 44 / 42
Connecting Cable	Power and Communication cable(H07RN-F)	mm ² x cores	0.75 X 4	0.75 X 4	0.75 x 4
Model Name		Unit	AJUQ36GH4	AJUQ48GH4	AJUQ60GH4
Power Supply			220-240, 1, 50/60	220-240, 1, 50/60	220-240, 1, 50/60
Power Supply Cable (included Earth)	No. x mm2		3C x 2.5	3C x 4.0	3C x 6.0
Casing Color			Warm Gray	Warm Gray	Warm Gray
Dimensions	Net	W x H x D	950 x 834 x 330	950 x 834 x 330	950 x 1,380 x 330
	Weight	Net, kg	57.7	61.5	83
Compressor	Type		LG Inverter Scroll	LG Inverter Scroll	LG Inverter Scroll
	Model		RJB036MBA x 1	RJB036MBA x 1	RJB036MAA x 1
	Motor type		BLDC	BLDC	BLDC
	Motor Output		3,371 x 1	3,371 x 1	3,198 x 1
Refrigerant	Type		R410A	R410A	R410A
	GWP (Global Warming Potential)		-	-	-
	Precharged Amount, g (oz)		1,900 (67)	2,200 (77.6)	3600 (127)
	Control		Electronic Expansion Valve	Electronic Expansion Valve	Electronic Expansion Valve
	Chargeless-Pipe Length, m (ft)		7.5 (24.6)	7.5 (24.6)	7.5 (24.6)
	Additional Charging Volume, g/m		40	40	40
Refrigerant Oil	Type		PVE or POE	PVE or POE	FVC68D
	Charged volume		1,100 x 1	1,100 x 1	1,100 x 1
Heat Exchanger	(Row x Column x FPI) x No.		(2 x 40 x 21) x 1	(3 x 40 x 21) x 1	(2 x 32 x 16) x 2
Fan	Type		Propeller	Propeller	Propeller
	Air Flow Rate	m ³ /min x No.	70 x 1	70 x 1	70 x 2
Fan Motor	Type		BLDC	BLDC	BLDC
	Output	W x No.	124.2 x 1	124.2 x 1	124 x 1
Sound Pressure Level	Cooling	Rated dB(A)	55	57	59
Piping Connections	Liquid	Outer Dia.	Ø 9.52 (3/8)	Ø 9.52 (3/8)	Ø 9.52 (3/8)
	Gas	Outer Dia.	Ø 15.88 (5/8)	Ø 15.88 (5/8)	Ø 19.05 (5/8)
Piping Length		Min./Max. (m (ft.))	5 (16.4) / 50 (164.0)	5 (16.4) / 50 (164.0)	5 (16.4) / 50 (164.0)
Maximum Height Difference (ODU - IDU)		Max. (m(ft.))	30 (98.4)	30 (98.4)	30 (98.4)

CONTROL SOLUTION

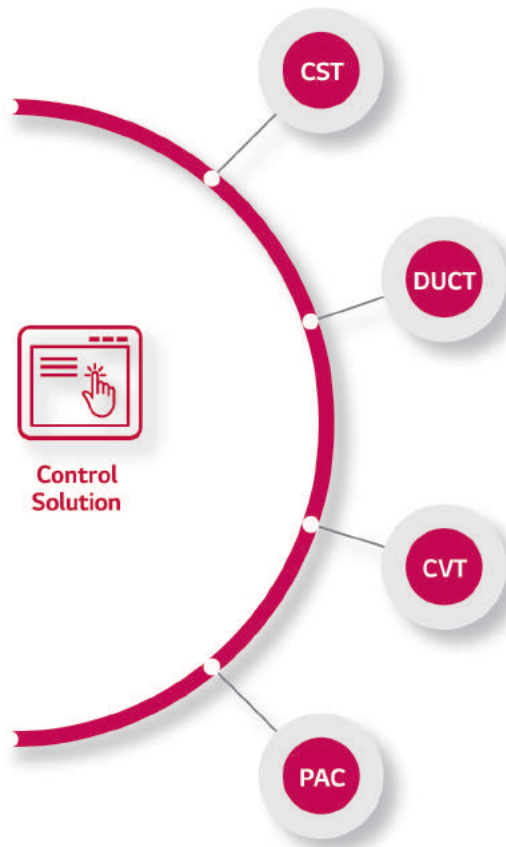

CENTRAL CONTROL SOLUTION



- 5" Touch controller
- PI485GW required
- Individual controller Lock
- Yearly schedule
- Max 64 Indoor unit

INDIVIDUAL CONTROLLER



- 4.3" color display with a modern design
- Soft touch button
- Yearly schedule

DRY CONTACT SOLUTION



- 1 or 2 contact input
- With 3rd Party Thermostat
- With Automation system

CONTROLLER LINE UP

Smart management for a variety of usages.

CENTRAL CONTROLLER



ACP 5

- Max. 256 unit
- PC, Smartphone, Tablet Control
- Yearly schedule
- BACnet / Modbus Gateway
- Individual controller Lock
- Operation log
- Floor map view



AC Smart 5

- Max. 128 unit
- 10.2" touch
- Yearly schedule
- BACnet / Modbus Gateway
- Individual controller Lock
- Operation log
- Floor map view



AC Ez touch

- Max. 64 unit
- 5" touch
- Yearly schedule
- Individual controller Lock
- Operation log

INDIVIDUAL CONTROLLER



Standard II



Standard III (4.3" color)



Premium (5" touch color)



Wireless



LG Wi-Fi MODEM

BMS PROTOCOL GATEWAY



LonWorks

ETC. ACCESSORIES



Dry Contact



PI485GW